

ITEM	QTY	DESCRIPTION	MATERIAL
19	1	GEAR BOX	CAST IRON
18	2	KEY	STEEL
17	3	*O* RING	ASTM D2000 (NBR)
16	4	SHORT BUSHING	ASTM B584 C83600
15	1	NAME PLATE	ALUMINIUM
14	4	PLATE RIVETS	ALUMINIUM
13	1	LONG BUSHING	ASTM B584 C83600
12	1	UPPER SHAFT	ASTM A582 SS41600
11	3	TAPER PIN	ASTM A582 SS41600
10	1	DISC	ASTM A635/C954/CF8M
9	1	LOWER SHAFT	ASTM A582 SS41600
8	1	SEAT	ASTM D2000 EPDM/NBR
7	1	BODY	ASTM A536 65-45-12
6	1	LOWEER BUSHING	ASTM B584 C83600
5	1	BEARING	BEARING STEEL
4	1	GASKET	STEEL
3	1	*O* RING	ASTM D2000 (NBR)
2	4	SCREW	STEEL
1	1	END COVER	ASTM A536 65-45-12

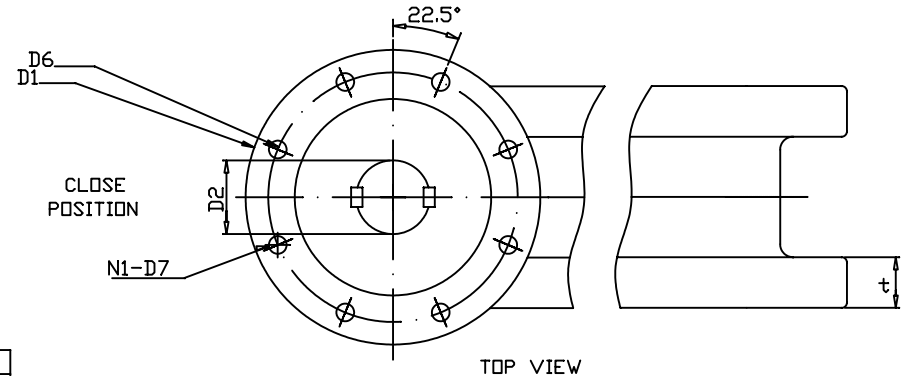

- TECHNICAL REQUIREMENT**
1. THE FACE TO FACE OF BODY COMPLY WITH MSS SP-67-90 AND AP1609 AND ISO5752
 2. TOP CONNECTION: ISO5211, ROUND STEM WITH KEY
 3. DIMENSIONS FOR MOUNTING FLANGE FOR DN750, DN900, DN1050, DN1200 ARE ACCORDANCE WITH ANSIB16.1 125, FOR OTHERS CONFORM DIN2501/ISO2084 PN10.

TECHNICAL DATA	
NOMINAL PRESSURE	150 PSI
TEST PRESSURE	SEAT 165 PSI SHELL 225 PSI
WORKING TEMP. (Deg. C)	EPDM -35 TO 110 NBR -12 TO 82

SUBASSEMBLY PART NUMBER				
Trim	Part	Size	Figure No.	Style
763	300	XXX	397	000
979	300	XXX	397	000
980	300	XXX	397	000

SIZE	D1	D2	D3	D4	N2	D10	D6	N1	D7	D8	D9	L	L1	H1	H2	t	A	B	C	D	E	F	G	W	KEY	WEIGHT
28"	300	63.35	910	840	24	M33	254	8	18	695	675.62	163	169	520.2	1	54	590	230	470	140	170	360	1504.2	400	18X63	500kgs
30"	300	63.35	984	914.4	28	1 1/4-7UNC	254	8	18	744	725.5	167	173	560	660	54	590	230	470	140	170	360	1588	400	18X63	517kgs
32"	300	63.35	1015	950	24	M36	254	8	18	794.7	772.14	188	195	591.2	672	61	590	230	470	140	170	360	1623	400	18X63	601kgs
36"	300	75	1168	1050	32	1 1/2-6UNC	254	8	18	864.7	840.5	203	211	656	720	61	634	247	550	162	200	387	1763	400	20X100	795kgs
40"	300	85	1230	1085.8	28	M39	254	8	18	965	940.52	216	224	721	800	64	634	247	550	162	200	387	1908	400	20X100	864kgs
42"	300	95	1346	1257	36	1 1/2-6UNC	254	8	18	1030	999	251	261	777.2	858	67	810	320	650	236	200	473	2102	450	25X140	1128kgs
48"	350	105	1511	1423	44	1 1/2-6UNC	298	8	22	1160	1126.6	276	286	864	941	70	810	320	650	236	200	473	2272	450	28X140	1512kgs

ABZ MANUFACTURING, Inc.

28"-48" Figure 397 Valve
Standard Flanged Pattern

BODY: Flanged w/360° Top Plate
DISC: Standard
STEM: Two Piece w/Keyway
SEAT: Elastomer

DATE: 10-01-04

DRAWING NO. ED 397-28-48