



# Bradford™ Bevel Seat Fittings

C

Bevel Seat

## A Complete Bevel Seat Connection

## Product Specifications

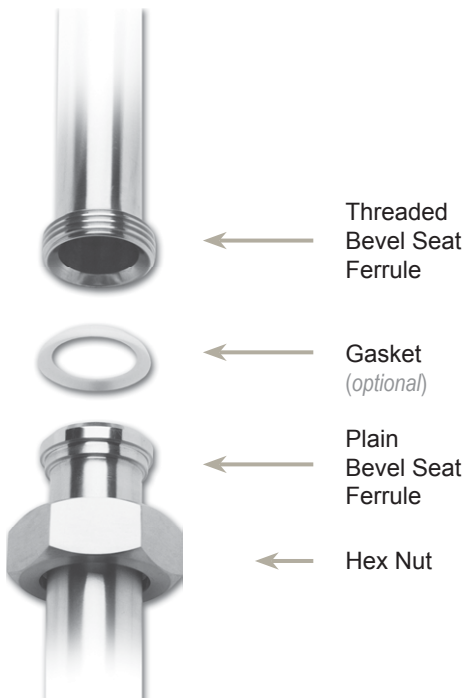

**Size range:**

- 1" - 4" OD tube

**Materials:**

- G = 304 stainless steel
- R = 316L stainless steel
- other alloys are available

**Finish:**

- 3A sanitary finish ID and OD

**Available At:**



### Bay Port Valve & Fitting, Inc.

P.O. Box 315      Phone: (863) 425-0023  
 2295 S.R. 37 South      (800) 369-0194  
 Mulberry, FL. 33860      Fax: (863) 425-5091

[www.bayportvalve.com](http://www.bayportvalve.com)

## Index

Nuts .....	39	Elbows .....	44
Wrenches .....	39	Reducers .....	45
Ferrules .....	40-42	Miscellaneous .....	46
Caps .....	43	Gaskets .....	47-48
Adapters .....	43		

## Bevel Seat Nuts

### Union Hex Nuts - 13H

- 400 PSI maximum

Tube OD	A	B	304 Stainless Steel (CF8) Part Number
1"	.906	1.812	<b>13H-G100</b>
1½"	.968	2.406	<b>13H-G150</b>
2"	1.062	3.000	<b>13H-G200</b>
2½"	1.187	3.594	<b>13H-G250</b>
3"	1.281	4.188	<b>13H-G300</b>
4"	1.500	5.438	<b>13H-G400</b>

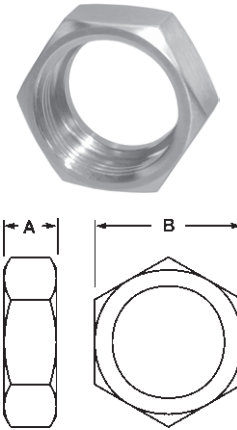

C  
Bevel  
Seat

## Bevel Seat Wrenches

### Single Side Hex Wrenches - 25H

Tube OD	A	B	Weight lbs.	Aluminum Part Number
1"	10.500	1.812	.64	<b>25H-100</b>
1½"	12.000	2.406	.86	<b>25H-150</b>
2"	14.000	3.000	1.76	<b>25H-200</b>
2½"	16.250	3.594	2.40	<b>25H-250</b>
3"	18.500	4.188	3.04	<b>25H-300</b>
4"	19.500	5.438	3.62	<b>25H-400</b>

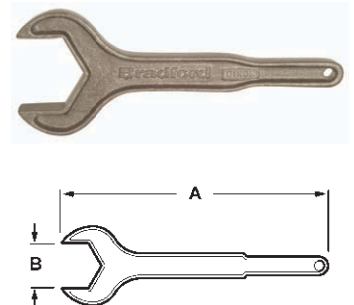

### Two Sided Hex Wrenches - 25H

Tube OD	A	B	C	Weight lbs.	Aluminum Part Number
1½" x 1"	12.000	2.406	1.812	1.00	<b>25H-150100</b>
2" x 1½"	14.000	3.000	2.406	1.75	<b>25H-200150</b>
2½" x 2"	16.500	3.594	3.000	2.80	<b>25H-250200</b>
3" x 2"	18.000	4.188	3.000	3.20	<b>25H-300200</b>
3" x 2½"	18.000	4.188	3.594	3.70	<b>25H-300250</b>

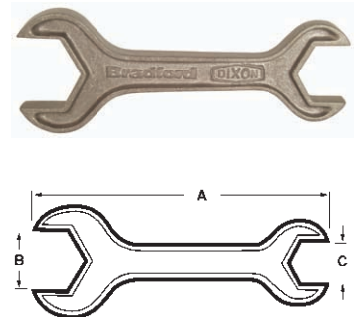

## Bevel Seat Ferrules

C

Bevel Seat

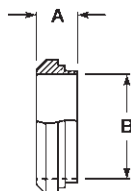

### 3 Short Plain Bevel Seat Weld Ferrules - 14PRF

Tube OD	A	B	304 Stainless Steel Part Number	316L Stainless Steel Part Number
1"	.718	.870	<b>14PRF-G100</b>	<b>14PRF-R100</b>
1½"	.718	1.370	<b>14PRF-G150</b>	<b>14PRF-R150</b>
2"	.750	1.870	<b>14PRF-G200</b>	<b>14PRF-R200</b>
2½"	.875	2.370	<b>14PRF-G250</b>	<b>14PRF-R250</b>
3"	.906	2.870	<b>14PRF-G300</b>	<b>14PRF-R300</b>
4"	1.031	3.834	<b>14PRF-G400</b>	<b>14PRF-R400</b>

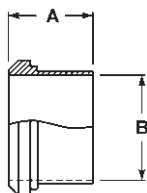

### 3 Long Plain Bevel Seat Weld Ferrules - 14A

Tube OD	A	B	304 Stainless Steel Part Number	316L Stainless Steel Part Number
1"	1.375	.870	<b>14A-G100</b>	<b>14A-R100</b>
1½"	1.500	1.370	<b>14A-G150</b>	<b>14A-R150</b>
2"	1.500	1.870	<b>14A-G200</b>	<b>14A-R200</b>
2½"	1.750	2.370	<b>14A-G250</b>	<b>14A-R250</b>
3"	1.750	2.870	<b>14A-G300</b>	<b>14A-R300</b>
4"	1.750	3.834	<b>14A-G400</b>	<b>14A-R400</b>

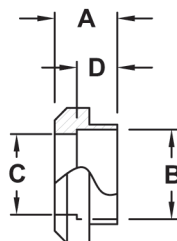

### Recessed Plain Bevel Seat Weld Ferrules - 14

Tube OD	A	B	C	D	304 Stainless Steel Part Number
1"	.750	1.000	.870	.500	<b>14-G100</b>
1½"	.875	1.500	1.370	.625	<b>14-G150</b>
2"	.969	2.000	1.870	.688	<b>14-G200</b>
2½"	1.062	2.500	2.370	.750	<b>14-G250</b>
3"	1.125	3.000	2.870	.813	<b>14-G300</b>
4"	1.250	4.000	3.834	.938	<b>14-G400</b>

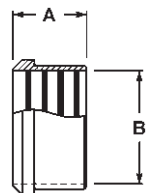

### 3\* Recessless Plain Bevel Seat Ferrules - 14R

- for expanding

Tube OD	A	B	304 Stainless Steel Part Number
1"	.750	1.000	<b>14R-G100</b>
1½"	1.125	1.500	<b>14R-G150</b>
2"	1.312	2.000	<b>14R-G200</b>
2½"	1.375	2.500	<b>14R-G250</b>
3"	1.437	3.000	<b>14R-G300</b>
4"	1.500	4.000	<b>14R-G400</b>

\* for use when modifying or repairing existing on-site farm milk handling systems

## Bevel Seat Ferrules

### Light Wall Tank Plain Bevel Seat Ferrules - 14WL

Tube OD	A	B	304 Stainless Steel Part Number
1"	2.000	.870	<b>14WL-G100</b>
1½"	2.250	1.370	<b>14WL-G150</b>
2"	2.500	1.870	<b>14WL-G200</b>
2½"	2.750	2.370	<b>14WL-G250</b>
3"	3.000	2.870	<b>14WL-G300</b>
4"	4.000	3.834	<b>14WL-G400</b>

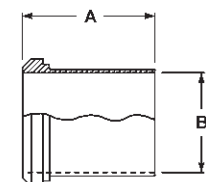

C  
Bevel Seat

### Heavy Wall Tank Plain Bevel Seat Ferrules - 14W

Tube OD	A	B	C	304 Stainless Steel Part Number
1"	2.375	.870	1.160	<b>14W-G100</b>
1½"	2.531	1.370	1.676	<b>14W-G150</b>
2"	2.781	1.870	2.192	<b>14W-G200</b>
2½"	3.062	2.370	2.708	<b>14W-G250</b>
3"	3.531	2.870	3.224	<b>14W-G300</b>
4"	4.312	3.834	4.256	<b>14W-G400</b>

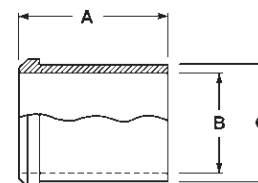
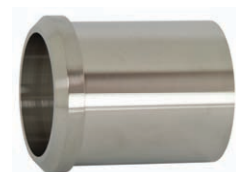

### Short Threaded Bevel Seat Weld Ferrules - 15TRF

Tube OD	A	B	304 Stainless Steel Part Number	316L Stainless Steel Part Number
1"	.718	.870	<b>15TRF-G100</b>	<b>15TRF-R100</b>
1½"	.718	1.370	<b>15TRF-G150</b>	<b>15TRF-R150</b>
2"	.750	1.870	<b>15TRF-G200</b>	<b>15TRF-R200</b>
2½"	.875	2.370	<b>15TRF-G250</b>	<b>15TRF-R250</b>
3"	.906	2.870	<b>15TRF-G300</b>	<b>15TRF-R300</b>
4"	1.031	3.834	<b>15TRF-G400</b>	<b>15TRF-R400</b>

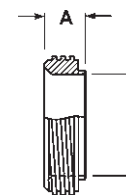

### Long Threaded Bevel Seat Weld Ferrules - 15A

Tube OD	A	B	304 Stainless Steel Part Number	316L Stainless Steel Part Number
1"	1.375	.870	<b>15A-G100</b>	<b>15A-R100</b>
1½"	1.500	1.370	<b>15A-G150</b>	<b>15A-R150</b>
2"	1.500	1.870	<b>15A-G200</b>	<b>15A-R200</b>
2½"	1.750	2.370	<b>15A-G250</b>	<b>15A-R250</b>
3"	1.750	2.870	<b>15A-G300</b>	<b>15A-R300</b>
4"	1.750	3.834	<b>15A-G400</b>	<b>15A-R400</b>

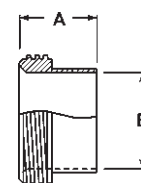

## Bevel Seat Ferrules

C

Bevel Seat

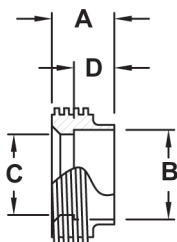

### Recessed Threaded Bevel Seat Ferrules - 15

Tube OD	A	B	C	D	304 Stainless Steel Part Number
1"	.812	1.000	.870	.500	<b>15-G100</b>
1½"	.875	1.500	1.370	.625	<b>15-G150</b>
2"	1.031	2.000	1.870	.687	<b>15-G200</b>
2½"	1.125	2.500	2.370	.750	<b>15-G250</b>
3"	1.250	3.000	2.870	.812	<b>15-G300</b>
4"	1.375	4.000	3.834	.937	<b>15-G400</b>

3 \*

### Recessless Threaded Bevel Seat Ferrules - 15R

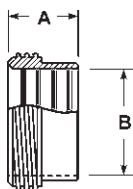

- for expanding

Tube OD	A	B	304 Stainless Steel Part Number
1"	.812	1.000	<b>15R-G100</b>
1½"	1.125	1.500	<b>15R-G150</b>
2"	1.375	2.000	<b>15R-G200</b>
2½"	1.500	2.500	<b>15R-G250</b>
3"	1.675	3.000	<b>15R-G300</b>
4"	1.675	4.000	<b>15R-G400</b>

\* for use when modifying or repairing existing on-site farm milk handling systems

3

### Light Wall Tank Threaded Bevel Seat Ferrules - 15WL

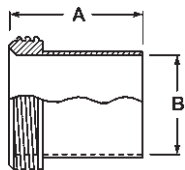

Tube OD	A	B	304 Stainless Steel Part Number
1"	2.000	.870	<b>15WL-G100</b>
1½"	2.250	1.370	<b>15WL-G150</b>
2"	2.500	1.870	<b>15WL-G200</b>
2½"	2.750	2.370	<b>15WL-G250</b>
3"	3.000	2.870	<b>15WL-G300</b>
4"	4.000	3.834	<b>15WL-G400</b>

3

### Heavy Wall Tank Threaded Bevel Seat Ferrules - 15W

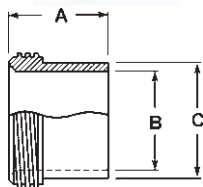

Tube OD	A	B	C	304 Stainless Steel Part Number	316L Stainless Steel Part Number
1"	1.500	.870	1.160	<b>15W-G100</b>	<b>15W-R100</b>
1½"	1.625	1.370	1.676	<b>15W-G150</b>	<b>15W-R150</b>
2"	1.750	1.870	2.192	<b>15W-G200</b>	<b>15W-R200</b>
2½"	1.750	2.370	2.708	<b>15W-G250</b>	<b>15W-R250</b>
3"	1.812	2.870	3.224	<b>15W-G300</b>	<b>15W-R300</b>
4"	2.125	3.834	4.256	<b>15W-G400</b>	<b>15W-R400</b>

## Bevel Seat End Caps

### Plain Bevel Seat Solid End Caps - 16A

Tube OD	A	304 Stainless Steel Part Number	316L Stainless Steel Part Number
1"	1.312	<b>16A-G100</b>	<b>16A-R100</b>
1½"	1.843	<b>16A-G150</b>	<b>16A-R150</b>
2"	2.375	<b>16A-G200</b>	<b>16A-R200</b>
2½"	2.906	<b>16A-G250</b>	<b>16A-R250</b>
3"	3.437	<b>16A-G300</b>	<b>16A-R300</b>
4"	4.500	<b>16A-G400</b>	<b>16A-R400</b>



**C**  
Bevel Seat

## Bevel Seat Adapters

### Plain Bevel Seat Tygon® Hose Adapters - 14AHT

Tube OD	A	B	304 Stainless Steel Part Number
1"	4.688	1.000	<b>14AHT-G100</b>
1½"	4.719	1.500	<b>14AHT-G150</b>
2"	4.719	2.000	<b>14AHT-G200</b>
2½"	4.844	2.500	<b>14AHT-G250</b>
3"	4.906	3.000	<b>14AHT-G300</b>
4"	5.218	4.000	<b>14AHT-G400</b>

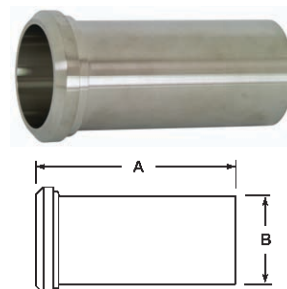

### Threaded Bevel Seat Tygon® Hose Adapters - 15AHT

Tube OD	A	B	304 Stainless Steel Part Number
1"	4.500	1.000	<b>15AHT-G100</b>
1½"	4.500	1.500	<b>15AHT-G150</b>
2"	4.500	2.000	<b>15AHT-G200</b>
2½"	4.500	2.500	<b>15AHT-G250</b>
3"	4.500	3.000	<b>15AHT-G300</b>
4"	5.000	4.000	<b>15AHT-G400</b>

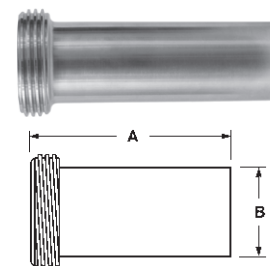

### Plain Bevel Seat Rubber Hose Adapters - 14AHR

Tube OD	A	B	C	304 Stainless Steel Part Number
1"	1.687	.870	1.000	<b>14AHR-G100</b>
1½"	1.687	1.370	1.500	<b>14AHR-G150</b>
2"	2.312	1.870	2.000	<b>14AHR-G200</b>
2½"	2.343	2.370	2.500	<b>14AHR-G250</b>
3"	3.500	2.870	3.000	<b>14AHR-G300</b>
4"	4.000	3.834	4.000	<b>14AHR-G400</b>

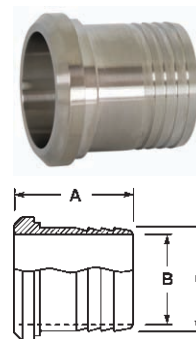

Other types of bevel seat adapters are available call Dixon Sanitary for information



15AHR

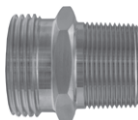

21



22

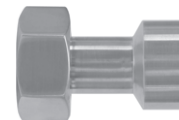

14-18

## Bevel Seat Elbows

C

Bevel Seat

### 3 Threaded Bevel Seat x Threaded Bevel Seat 90° Elbows - B2C

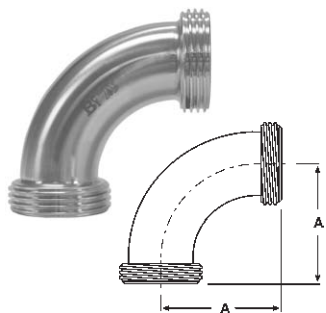

Tube OD	A	304 Stainless Steel Part Number
1"	2.218	<b>B2C-G100</b>
1½"	2.968	<b>B2C-G150</b>
2"	3.750	<b>B2C-G200</b>
2½"	4.625	<b>B2C-G250</b>
3"	5.406	<b>B2C-G300</b>
4"	7.031	<b>B2C-G400</b>

### Threaded Bevel Seat x Plain Bevel Seat with Hex Nut 90° Elbows - B2F

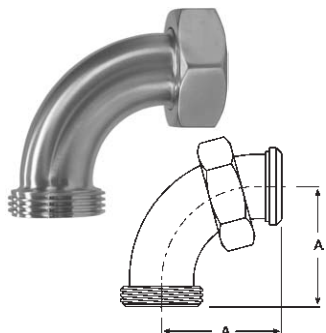

- hex nut is CF8 (304) stainless steel

Tube OD	A	304 Stainless Steel Part Number
1"	2.218	<b>B2F-G100</b>
1½"	2.968	<b>B2F-G150</b>
2"	3.750	<b>B2F-G200</b>
2½"	4.625	<b>B2F-G250</b>
3"	5.406	<b>B2F-G300</b>
4"	7.031	<b>B2F-G400</b>

### 3 Plain Bevel Seat x Plain Bevel Seat with Hex Nut 90° Elbows - B2E

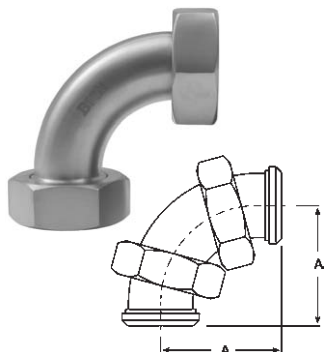

- hex nut is CF8 (304) stainless steel

Tube OD	A	304 Stainless Steel Part Number
1"	2.218	<b>B2E-G100</b>
1½"	2.968	<b>B2E-G150</b>
2"	3.750	<b>B2E-G200</b>
2½"	4.625	<b>B2E-G250</b>
3"	5.406	<b>B2E-G300</b>
4"	7.031	<b>B2E-G400</b>

### Threaded Bevel Seat x Plain Bevel Seat with Hex Nut 45° Elbows - B2P

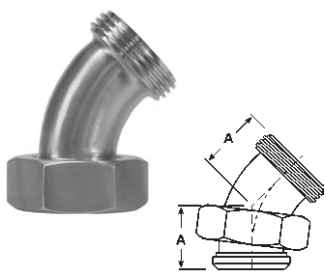

- hex nut is CF8 (304) stainless steel

Tube OD	A	304 Stainless Steel Part Number
1"	1.343	<b>B2P-G100</b>
1½"	1.655	<b>B2P-G150</b>
2"	2.000	<b>B2P-G200</b>
2½"	2.437	<b>B2P-G250</b>
3"	2.781	<b>B2P-G300</b>
4"	3.531	<b>B2P-G400</b>

Other types of bevel seat elbows are available call Dixon Sanitary for information



B2K

## Bevel Seat Reducers

### Plain Bevel Seat x Threaded Bevel Seat Concentric Reducers - B3115F

C  
Bevel Seat

Tube OD	A	304 Stainless Steel Part Number
1½" x 1"	3.438	<b>B3115F-G150100</b>
2" x 1½"	3.468	<b>B3115F-G200150</b>
2½" x 2"	3.625	<b>B3115F-G250200</b>
3" x 2"	5.656	<b>B3115F-G300200</b>
3" x 2½"	3.781	<b>B3115F-G300250</b>
4" x 3"	5.937	<b>B3115F-G400300</b>

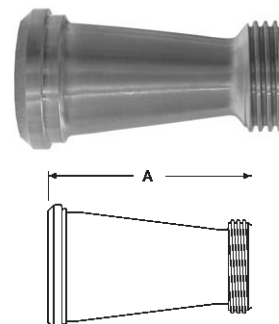

### Threaded Bevel Seat x Threaded Bevel Seat Concentric Reducers - B31TT

Tube OD	A	304 Stainless Steel Part Number
1½" x 1"	3.438	<b>B31TT-G150100</b>
2" x 1½"	3.468	<b>B31TT-G200150</b>
2½" x 2"	3.625	<b>B31TT-G250200</b>
3" x 2"	5.656	<b>B31TT-G300200</b>
3" x 2½"	3.781	<b>B31TT-G300250</b>
4" x 3"	5.937	<b>B31TT-G400300</b>

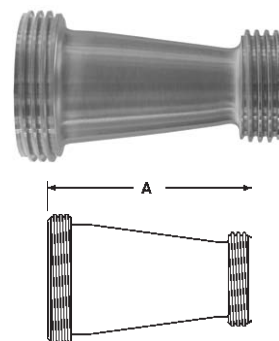

### Threaded Bevel Seat x Plain Bevel Seat with Hex Nut Concentric Reducers - B31TP

- hex nut is CF8 (304) stainless steel

Tube OD	A	304 Stainless Steel Part Number
1½" x 1"	3.438	<b>B31TP-G150100</b>
2" x 1½"	3.468	<b>B31TP-G200150</b>
2½" x 2"	3.625	<b>B31TP-G250200</b>
3" x 2"	5.656	<b>B31TP-G300200</b>
3" x 2½"	3.781	<b>B31TP-G300250</b>
4" x 3"	5.937	<b>B31TP-G400300</b>

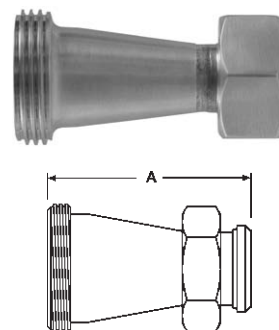

Other types of bevel seat reducers are available call Dixon Sanitary for information



B3114F



B3215F



B3214F

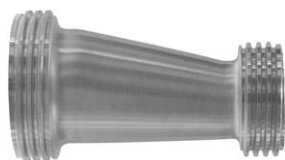

B32-TT



B32-TP



## Miscellaneous Bevel Seat Configurations

*Other types of bevel seat configurations are available call Dixon Sanitary for information*

C

Bevel  
Seat



B7



B7A



B7B



B9



B9A



B28A



B28B

## Bevel Seat Gaskets

### Buna-N - Black

Size	Part Number
1"	<b>40BS-O100</b>
1½"	<b>40BS-O150</b>
2"	<b>40BS-O200</b>
2½"	<b>40BS-O250</b>
3"	<b>40BS-O300</b>
4"	<b>40BS-O400</b>

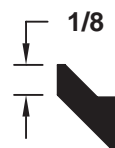

- color code: red dot
- meets 21CFR 177.2600
- refer to pages 216-218 for compatibility information

C  
Bevel  
Seat

### Buna-N - Black Flat

Size	Part Number
1"	<b>40BS-F100</b>
1½"	<b>40BS-F150</b>
2"	<b>40BS-F200</b>
2½"	<b>40BS-F250</b>
3"	<b>40BS-F300</b>
4"	<b>40BS-F400</b>



- color code: red dot
- refer to pages 216-218 for compatibility information

### EPDM

Size	Part Number
1"	<b>40BS-E100</b>
1½"	<b>40BS-E150</b>
2"	<b>40BS-E200</b>
2½"	<b>40BS-E250</b>
3"	<b>40BS-E300</b>
4"	<b>40BS-E400</b>

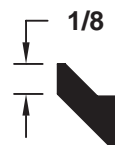

- color code: three green dots
- peroxide cured
- meets 21CFR 177.2600
- passed U.S.P. Class VI Cytotoxicity testing
- refer to pages 216-218 for compatibility information

### FKM (Viton®)

Size	Part Number
1"	<b>40BS-Y100</b>
1½"	<b>40BS-Y150</b>
2"	<b>40BS-Y200</b>
2½"	<b>40BS-Y250</b>
3"	<b>40BS-Y300</b>
4"	<b>40BS-Y400</b>

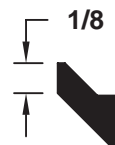

- color code: one white dot and one yellow dot
- peroxide cured
- meets 21CFR 177.2600
- passed U.S.P. Class VI Cytotoxicity testing
- refer to pages 216-218 for compatibility information

## Bevel Seat Gaskets

### Silicone - White

C

Bevel  
Seat

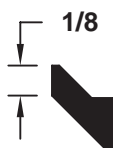

- color code: no dot
- peroxide cured
- meets 21CFR 177.2600
- passed U.S.P. Class VI Cytotoxicity testing
- refer to pages 216-218 for compatibility information

Size	Part Number
1"	<b>40BS-X100</b>
1½"	<b>40BS-X150</b>
2"	<b>40BS-X200</b>
2½"	<b>40BS-X250</b>
3"	<b>40BS-X300</b>
4"	<b>40BS-X400</b>

### PTFE (Teflon®)

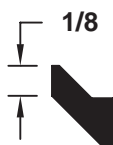

- color code: no dot
- meets 21CFR 177.1550
- passed U.S.P. Class VI Cytotoxicity testing
- refer to pages 216-218 for compatibility information

Size	Part Number
1"	<b>40BS-S100</b>
1½"	<b>40BS-S150</b>
2"	<b>40BS-S200</b>
2½"	<b>40BS-S250</b>
3"	<b>40BS-S300</b>
4"	<b>40BS-S400</b>

**CAUTION**

PTFE (Teflon®) is a material subject to plastic flow. When cycled through heat and then cooled down in process lines, PTFE gaskets will not return to the original configuration and it will continue to compress as the cycling continues. This plastic flow will allow leakage if clamp torques are not maintained.

### Heavy PTFE (Teflon®)

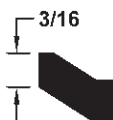

- color code: no dot
- meets 21CFR 177.1550
- passed U.S.P. Class VI Cytotoxicity testing
- refer to pages 216-218 for compatibility information

Size	Part Number
1"	<b>40BS-H100</b>
1½"	<b>40BS-H150</b>
2"	<b>40BS-H200</b>
2½"	<b>40BS-H250</b>
3"	<b>40BS-H300</b>
4"	<b>40BS-H400</b>

**CAUTION**

PTFE (Teflon®) is a material subject to plastic flow. When cycled through heat and then cooled down in process lines, PTFE gaskets will not return to the original configuration and it will continue to compress as the cycling continues. This plastic flow will allow leakage if clamp torques are not maintained.