

Bradford™ Unpolished Weld Fittings

A Complete Weld Connection

Product Specifications



← Weld end



← Weld end

Size range:

- ½" - 12" OD tube

Materials:

- G = 304 stainless steel
- R = 316L stainless steel
- other alloys are available

Finish:

- unpolished

G
Unpolished
Fittings

Available At:



Bay Port Valve & Fitting, Inc.

P.O. Box 315 Phone: (863) 425-0023
 2295 S.R. 37 South (800) 369-0194
 Mulberry, FL. 33860 Fax: (863) 425-5091

www.bayportvalve.com

Index

Elbows	75	Reducers	78
Caps	76	Miscellaneous	79
Adapters	76	Flanges	80
Tees	77	Flange Gaskets	80

Unpolished Elbows

Unpolished 90° Weld Elbows with Tangents - B2S

Tube OD	A	Nominal Wall	304 Stainless Steel Part Number	316L Stainless Steel Part Number
½"	3.000	.065	---	B2S-R50U
¾"	3.000	.065	---	B2S-R75U
1"	2.062	.065	B2S-G100U	B2S-R100U
1½"	2.937	.065	B2S-G150U	B2S-R150U
2"	4.062	.065	B2S-G200U	B2S-R200U
2½"	5.187	.065	B2S-G250U	B2S-R250U
3"	6.312	.065	B2S-G300U	B2S-R300U
4"	8.312	.083	B2S-G400U	B2S-R400U

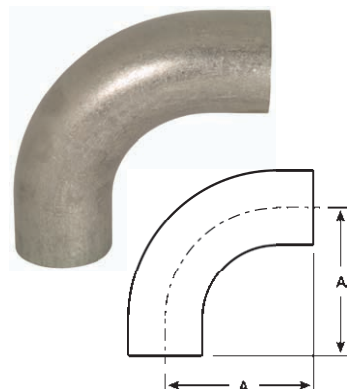

G
Unpolished
Fittings

Unpolished 90° Weld Elbows - B2WCL

Tube OD	A	Nominal Wall	304 Stainless Steel Part Number	316L Stainless Steel Part Number
½"	1.125	.065	---	B2WCL-R50U
¾"	1.125	.065	---	B2WCL-R75U
1"	1.500	.065	B2WCL-G100U	B2WCL-R100U
1½"	2.250	.065	B2WCL-G150U	B2WCL-R150U
2"	3.000	.065	B2WCL-G200U	B2WCL-R200U
2½"	3.750	.065	B2WCL-G250U	B2WCL-R250U
3"	4.500	.065	B2WCL-G300U	B2WCL-R300U
4"	6.000	.083	B2WCL-G400U	B2WCL-R400U
6"	9.000	.109	B2WCL-G600U	B2WCL-R600U
8"	12.000	.120	B2WCL-G800U	B2WCL-R800U
10"	15.000	.109	B2WCL-G1000U	B2WCL-R1000U
12"	18.000	.120	B2WCL-G1200U	B2WCL-R1200U

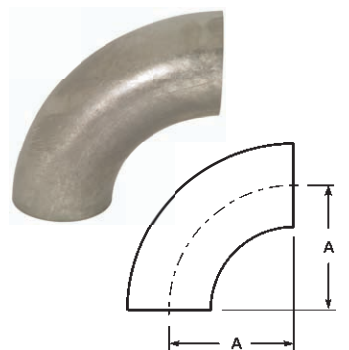

Unpolished 45° Weld Elbows with Tangents - B2KS

Tube OD	A	Nominal Wall	304 Stainless Steel Part Number	316L Stainless Steel Part Number
½"	2.250	.065	---	B2KS-R50U
¾"	2.250	.065	---	B2KS-R75U
1"	1.188	.065	B2KS-G100U	B2KS-R100U
1½"	1.625	.065	B2KS-G150U	B2KS-R150U
2"	2.312	.065	B2KS-G200U	B2KS-R200U
2½"	3.000	.065	B2KS-G250U	B2KS-R250U
3"	3.688	.065	B2KS-G300U	B2KS-R300U
4"	4.812	.083	B2KS-G400U	B2KS-R400U



Unpolished 45° Weld Elbows - B2WK

Tube OD	A	R	Nominal Wall	304 Stainless Steel Part Number	316L Stainless Steel Part Number
½"	.466	1.125	.065	---	B2WK-R50U
¾"	.466	1.125	.065	---	B2WK-R75U
1"	.625	1.500	.065	B2WK-G100U	B2WK-R100U
1½"	.937	2.250	.065	B2WK-G150U	B2WK-R150U
2"	1.250	3.000	.065	B2WK-G200U	B2WK-R200U
2½"	1.562	3.750	.065	B2WK-G250U	B2WK-R250U
3"	1.875	4.500	.065	B2WK-G300U	B2WK-R300U
4"	2.500	6.000	.083	B2WK-G400U	B2WK-R400U
6"	3.750	9.000	.109	B2WK-G600U	B2WK-R600U
8"	5.000	12.000	.120	B2WK-G800U	B2WK-R800U
10"	6.250	15.000	.109	B2WK-G1000U	B2WK-R1000U
12"	7.500	18.000	.120	B2WK-G1200U	B2WK-R1200U

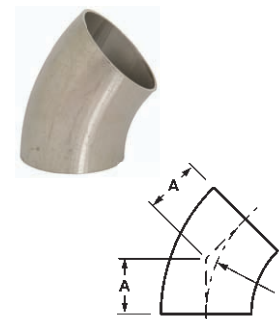

Unpolished End Caps

Unpolished End Caps - B16W

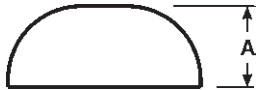

Tube OD	A	304 Stainless Steel Part Number	316L Stainless Steel Part Number
1/2"	.250	---	B16W-R50
3/4"	.312	---	B16W-R75
1"	.375	B16W-G100	B16W-R100
1 1/2"	.562	B16W-G150	B16W-R150
2"	.750	B16W-G200	B16W-R200
2 1/2"	1.000	B16W-G250	B16W-R250
3"	1.250	B16W-G300	B16W-R300
4"	1.500	B16W-G400	B16W-R400
6"	1.875	B16W-G600	B16W-R600
8"	2.500	B16W-G800	B16W-R800

G

Unpolished Fittings

Unpolished Adapters

Male NPT x Weld End Adapters - B19WB

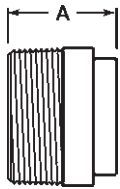

Tube OD	A	Nominal Wall	304 Stainless Steel Part Number	316L Stainless Steel Part Number
1/2"	1.625	.065	---	B19WB-R50
3/4"	1.625	.065	---	B19WB-R75
1"	1.750	.065	B19WB-G100	B19WB-R100
1 1/2"	1.750	.065	B19WB-G150	B19WB-R150
2"	1.812	.065	B19WB-G200	B19WB-R200
2 1/2"	2.312	.065	B19WB-G250	B19WB-R250
3"	2.500	.065	B19WB-G300	B19WB-R300
4"	2.562	.083	B19WB-G400	B19WB-R400

Female NPT x Weld End Adapters - B22WB

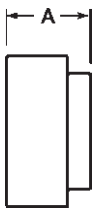

Tube OD	A	Nominal Wall	304 Stainless Steel Part Number	316L Stainless Steel Part Number
1/2"	1.250	.065	---	B22WB-R50
3/4"	1.625	.065	---	B22WB-R75
1"	1.750	.065	B22WB-G100	B22WB-R100
1 1/2"	1.750	.065	B22WB-G150	B22WB-R150
2"	1.812	.065	B22WB-G200	B22WB-R200
2 1/2"	2.312	.065	B22WB-G250	B22WB-R250
3"	2.500	.065	B22WB-G300	B22WB-R300
4"	2.500	.083	B22WB-G400	B22WB-R400

- see pages 214-215 for pipe thread information

Unpolished Tees

Unpolished Short Weld Tees - B7WWW

Tube OD	A	B	Nominal Wall	304 Stainless Steel Part Number	316L Stainless Steel Part Number
1"	2.250	1.125	.065	B7WWW-G100U	B7WWW-R100U
1½"	3.312	1.656	.065	B7WWW-G150U	B7WWW-R150U
2"	4.124	2.062	.065	B7WWW-G200U	B7WWW-R200U
2½"	4.688	2.344	.065	B7WWW-G250U	B7WWW-R250U
3"	5.188	2.594	.065	B7WWW-G300U	B7WWW-R300U
4"	6.876	3.438	.083	B7WWW-G400U	B7WWW-R400U

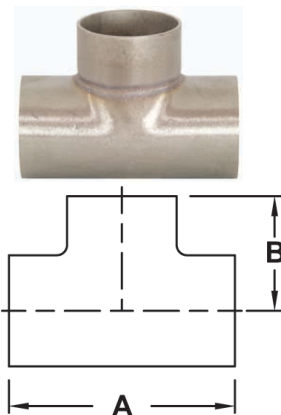

G
Unpolished Fittings

Unpolished Long Weld Tees - B7W

Tube OD	A	B	Nominal Wall	304 Stainless Steel Part Number	316L Stainless Steel Part Number
½"	3.750	1.875	.065	---	B7W-R50U
¾"	4.000	2.000	.065	---	B7W-R75U
1"	3.750	1.875	.065	B7W-G100U	B7W-R100U
1½"	4.500	2.250	.065	B7W-G150U	B7W-R150U
2"	6.000	3.000	.065	B7W-G200U	B7W-R200U
2½"	6.000	3.000	.065	B7W-G250U	B7W-R250U
3"	6.500	3.250	.065	B7W-G300U	B7W-R300U
4"	7.750	3.875	.083	B7W-G400U	B7W-R400U
6"	11.250	5.625	.109	B7W-G600U	B7W-R600U
8"	14.000	7.000	.120	B7W-G800U	B7W-R800U

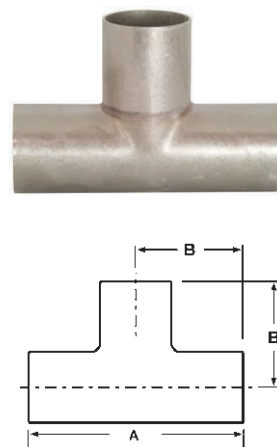

Unpolished Reducing Weld Tees - B7RWWW

Tube OD	A	B	C	D	Nominal Wall	304 Stainless Steel Part Number	316L Stainless Steel Part Number
1½" x ¾"	4.750	2.375	1.500	.750	.065	---	B7RWWW-R15075U
1½" x 1"	3.312	1.375	1.500	1.000	.065	B7RWWW-G150100U	B7RWWW-R150100U
2" x 1½"	5.750	2.625	2.000	.500	.065	---	B7RWWW-R20050U
2" x ¾"	5.750	2.625	2.000	.750	.065	---	B7RWWW-R20075U
2" x 1"	4.124	1.625	2.000	1.000	.065	B7RWWW-G200100U	B7RWWW-R200100U
2" x 1½"	4.124	1.906	2.000	1.500	.065	B7RWWW-G200150U	B7RWWW-R200150U
2½" x 1½"	4.688	2.156	2.500	1.500	.065	B7RWWW-G250150U	B7RWWW-R250150U
2½" x 2"	4.688	2.312	2.500	2.000	.065	B7RWWW-G250200U	B7RWWW-R250200U
3" x 1½"	5.188	2.406	3.000	1.500	.065	B7RWWW-G300150U	B7RWWW-R300150U
3" x 2"	5.188	2.562	3.000	2.000	.065	B7RWWW-G300200U	B7RWWW-R300200U
3" x 2½"	5.188	2.594	3.000	2.500	.065	B7RWWW-G300250U	B7RWWW-R300250U
4" x 1½"	6.876	2.906	4.000	1.500	.083	B7RWWW-G400150U	B7RWWW-R400150U
4" x 2"	6.876	3.062	4.000	2.000	.083	B7RWWW-G400200U	B7RWWW-R400200U
4" x 2½"	6.876	3.094	4.000	2.500	.083	B7RWWW-G400250U	B7RWWW-R400250U
4" x 3"	6.876	3.094	4.000	3.000	.083	B7RWWW-G400300U	B7RWWW-R400300U

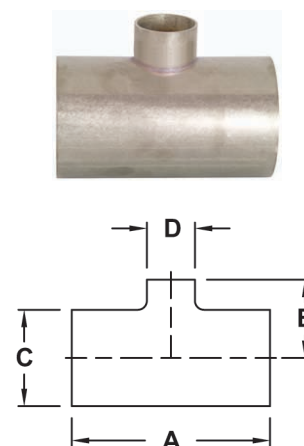

Unpolished Reducers

Unpolished Concentric Weld Reducers - B31W

Tube OD	A	Nominal Wall	304 Stainless Steel Part Number	316L Stainless Steel Part Number
¾" x ½"	1.000	.065	---	B31W-R7550U
1" x ¾"	1.000	.065	---	B31W-R10075U
1½" x ½"	4.000	.065	---	B31W-R15050U
1½" x ¾"	3.000	.065	---	B31W-R15075U
1½" x 1"	2.000	.065	B31W-G150100U	B31W-R150100U
2" x ¾"	5.000	.065	---	B31W-R20075U
2" x 1"	4.000	.065	B31W-G200100U	B31W-R200100U
2" x 1½"	2.000	.065	B31W-G200150U	B31W-R200150U
2½" x 1½"	4.000	.065	B31W-G250150U	B31W-R250150U
2½" x 2"	2.000	.065	B31W-G250200U	B31W-R250200U
3" x 1"	8.000	.065	B31W-G300100U	B31W-R300100U
3" x 1½"	6.000	.065	B31W-G300150U	B31W-R300150U
3" x 2"	4.000	.065	B31W-G300200U	B31W-R300200U
3" x 2½"	2.000	.065	B31W-G300250U	B31W-R300250U
4" x 1½"	10.000	.083	B31W-G400150U	B31W-R400150U
4" x 2"	8.000	.083	B31W-G400200U	B31W-R400200U
4" x 2½"	6.000	.083	B31W-G400250U	B31W-R400250U
4" x 3"	4.000	.083	B31W-G400300U	B31W-R400300U
6" x 3"	5.500	.109	B31W-G600300U	B31W-R600300U
6" x 4"	5.500	.109	B31W-G600400U	B31W-R600400U
8" x 4"	6.000	.120	B31W-G800400U	B31W-R800400U
8" x 6"	6.000	.120	B31W-G800600U	B31W-R800600U

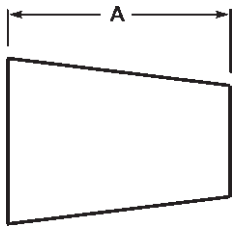

G
Unpolished
Fittings

Unpolished Eccentric Weld Reducers - B32W

Tube OD	A	Nominal Wall	304 Stainless Steel Part Number	316L Stainless Steel Part Number
¾" x ½"	1.000	.065	---	B32W-R7550U
1" x ½"	2.000	.065	---	B32W-R10050U
1" x ¾"	1.000	.065	---	B32W-R10075U
1½" x ½"	4.000	.065	---	B32W-R15050U
1½" x ¾"	3.000	.065	---	B32W-R15075U
1½" x 1"	2.000	.065	B32W-G150100U	B32W-R150100U
2" x ¾"	5.000	.065	---	B32W-R20075U
2" x 1"	4.000	.065	B32W-G200100U	B32W-R200100U
2" x 1½"	2.000	.065	B32W-G200150U	B32W-R200150U
2½" x 2"	2.000	.065	B32W-G250200U	B32W-R250200U
3" x 1½"	6.000	.065	B32W-G300150U	B32W-R300150U
3" x 2"	4.000	.065	B32W-G300200U	B32W-R300200U
3" x 2½"	2.000	.065	B32W-G300250U	B32W-R300250U
4" x 1½"	10.000	.083	B32W-G400150U	B32W-R400150U
4" x 2"	8.000	.083	B32W-G400200U	B32W-R400200U
4" x 3"	4.000	.083	B32W-G400300U	B32W-R400300U
6" x 4"	5.500	.109	B32W-G600400U	B32W-R600400U
8" x 6"	6.000	.120	B32W-G800600U	B32W-R800600U

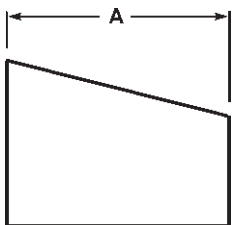

Miscellaneous Unpolished Configurations

Unpolished Weld Laterals - B28WA

Tube OD	A	B	C	Nominal Wall	316L Stainless Steel Part Number
1"	6.000	1.000	5.000	.065	B28WA-R100U
1½"	7.375	1.188	6.188	.065	B28WA-R150U
2"	8.750	1.625	7.125	.065	B28WA-R200U
2½"	10.000	1.500	8.500	.065	B28WA-R250U
3"	10.750	1.875	8.875	.065	B28WA-R300U
4"	12.812	2.015	10.750	.083	B28WA-R400U
6"	18.000	3.000	14.500	.109	B28WA-R600U

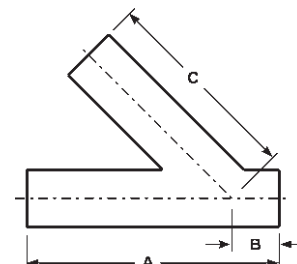

G
Unpolished Fittings

Unpolished Weld True Y - B28W

Tube OD	A	B	Nominal Wall	316L Stainless Steel Part Number
1"	2.000	2.438	.065	B28W-R100U
1½"	2.000	2.438	.065	B28W-R150U
2"	2.625	3.250	.065	B28W-R200U
2½"	3.370	4.125	.065	B28W-R250U
3"	4.000	4.875	.065	B28W-R300U
4"	5.375	5.375	.083	B28W-R400U

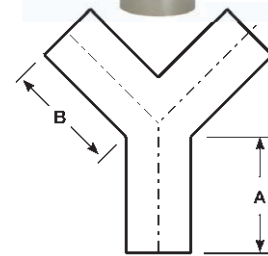

Unpolished Weld 180° Return Bends - B2WUL

- bends are 1.5 x tube diameter

Tube OD	A	B	Nominal Wall	316L Stainless Steel Part Number
1"	3.000	2.000	.065	B2WUL-R100U
1½"	4.500	3.000	.065	B2WUL-R150U
2"	6.000	4.000	.065	B2WUL-R200U
2½"	7.500	5.000	.065	B2WUL-R250U
3"	9.000	6.000	.065	B2WUL-R300U
4"	12.000	8.000	.083	B2WUL-R400U

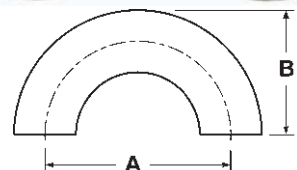

Weld End Blue Protection Covers - BCW

Size	Part Number
½"	BCW-050
¾"	BCW-075
1"	BCW-100
1½"	BCW-150
2"	BCW-200
2½"	BCW-250
3"	BCW-300
4"	BCW-400
6"	BCW-600
8"	BCW-800

- Use these covers to protect all weld ends on fittings and valves.
- vinyl plastic



Unpolished Flanges

Unpolished Tube Flanges - B38SL

- 150# flange

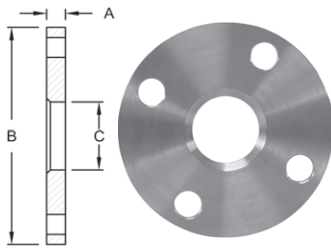

Tube OD	A	B	C	Bolts # / Hole	Bolt Circle	304 Stainless Steel Part Number	316L Stainless Steel Part Number
1"	.375	4.250	1.063	4/.625	3.125	B38SL-G100	B38SL-R100
1½"	.375	5.000	1.563	4/.625	3.875	B38SL-G150	B38SL-R150
2"	.437	6.000	2.063	4/.750	4.750	B38SL-G200	B38SL-R200
2½"	.437	7.000	2.563	4/.750	5.500	B38SL-G250	B38SL-R250
3"	.500	7.500	3.063	4/.750	6.000	B38SL-G300	B38SL-R300
4"	.562	9.000	4.063	8/.750	7.500	B38SL-G400	B38SL-R400
6"	.562	11.000	6.063	8/.875	9.500	B38SL-G600	B38SL-R600
8"	.687	13.500	8.063	8/.875	11.750	B38SL-G800	B38SL-R800

Unpolished Type A Stub Ends - 14VB

- typically used with B38SL flanges

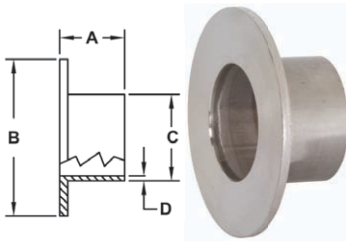

Tube OD	A	B	C	D	316L Stainless Steel Part Number
1"	1.625	2.000	.065	1.000	14VB-R100
1½"	1.750	2.875	.065	1.500	14VB-R150
2"	1.500	3.625	.065	2.000	14VB-R200
2½"	2.000	4.125	.065	2.500	14VB-R250
3"	2.250	5.000	.065	3.000	14VB-R300
4"	2.625	6.187	.084	4.000	14VB-R400
6"	3.000	8.500	.109	6.000	14VB-R600
8"	3.000	10.625	.120	8.000	14VB-R800
10"	3.500	12.450	.109	10.000	14VB-R1000

Unpolished Weld Neck Flanges - B38W

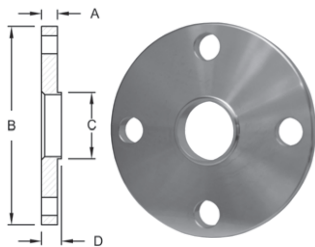

Tube OD	A	B	C	D	Bolts # / Hole	Bolt Circle	304 Stainless Steel Part Number	316L Stainless Steel Part Number
1"	.500	4.250	1.000	.375	4/.625	3.125	B38W-G100	B38W-R100
1½"	.500	5.000	1.500	.375	4/.625	3.875	B38W-G150	B38W-R150
2"	.625	6.000	2.000	.500	4/.750	4.750	B38W-G200	B38W-R200
2½"	.625	7.000	2.500	.500	4/.750	5.500	B38W-G250	B38W-R250
3"	.625	7.500	3.000	.500	4/.750	6.000	B38W-G300	B38W-R300
4"	.625	9.000	4.000	.500	8/.750	7.500	B38W-G400	B38W-R400
6"	.625	11.000	6.000	.500	8/.875	9.500	B38W-G600	B38W-R600

Other types of flanges are available call Dixon Sanitary for information

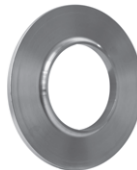

B14UB

Flange Gaskets

Neoprene



- standard drop-ring type all 1/16" thick

Size	Part Number	Size	Part Number
1"	NG10	3"	NG35
1¼"	NG15	4"	NG40
1½"	NG20	5"	NG50
2"	NG25	6"	NG60
2½"	NG30	8"	NG80