

Bradford™ Clamp Fittings

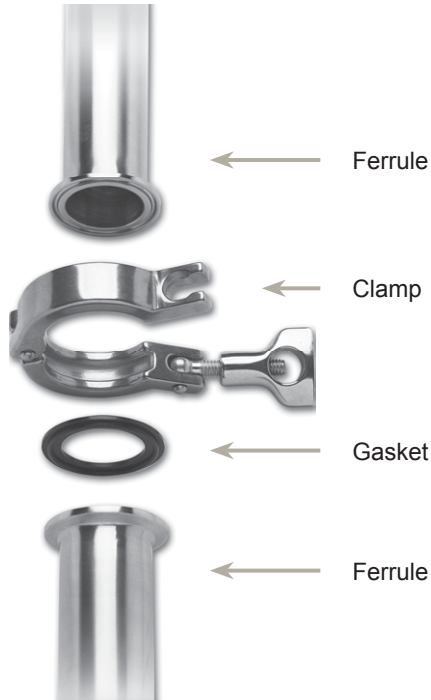

A Complete Clamping Connection

Product Specifications



Size range:

- ½" - 12" OD

Materials:

- G = 304 stainless steel
- R = 316L stainless steel
- other alloys are available

Finish:

- 3A sanitary finish ID and OD
- other finishes are available

This section contains tube OD materials. Please note: in sizes from ½" through 12", pipe is known by its nominal inside diameter, which differs from its actual inside diameter. To distinguish pipe sizes from actual measured diameters as used for tube, the term *iron pipe size (IPS)* or *nominal pipe size (NPS)* are usually used. For all pipe sizes, the outside diameter (OD) remains constant; the variations in wall thickness affect the inside diameter (ID).



Pipe size and Tube OD size materials are not interchangeable

Index

Clamps and Accessories	2-4	Tees	14
Ferrules	5-6	Reducers	15-16
Caps	7	Miscellaneous	17
Adapters	8-11	Gaskets	18-25
Elbows	12-13	APC Clamp Gaskets.....	25

Available At:



Bay Port Valve & Fitting, Inc.

P.O. Box 315 Phone: (863) 425-0023
 2295 S.R. 37 South (800) 369-0194
 Mulberry, FL. 33860 Fax: (863) 425-5091

Clamps

Service pressure ratings are based on the following parameters: matching elastomer gaskets and weld ferrules properly aligned and assembled with the clamps tightened to the required torques. Tests are done hydrostatically with no water hammer or shock loads. Please note the pressure ratings of the described unions may be above the recommended pipe line operating pressures. SAFETY
ALFR

Single Pin Squeeze Clamps - 13MHHM-Q

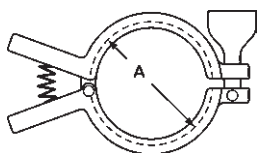

Tube OD	Service Pressure Rating @ 70°F *	Service Pressure Rating @ 250°F *	A	Part Number
½" - ¾"	1500	1200	1.062	13MHHM-Q75
1" - 1½"	500	300	2.122	13MHHM-Q100150
2"	450	250	2.654	13MHHM-Q200
2½"	400	200	3.185	13MHHM-Q250
3"	350	175	3.717	13MHHM-Q300
4"	300	150	4.820	13MHHM-Q400

* wing nut tightened to 25 in. lb. of torque



Tale of Two Clamps video

Scan me with your Smart Phone. No reader? Download a free QR-Code 2D barcode reader. <http://www.mobile-barcodes.com/qr-code-software/>

Single Pin Heavy Duty Clamps with Cross Hole Wing Nut - 13MHHM

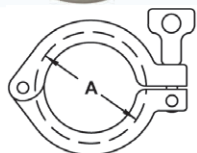

Tube OD	Service Pressure Rating @ 70°F *	Service Pressure Rating @ 250°F *	A	Part Number
½" - ¾"	1500	1200	1.062	13MHHM50-75
1" - 1½"	500	300	2.122	13MHHM100-150
2"	450	250	2.654	13MHHM200
2½"	400	200	3.185	13MHHM250
3"	350	175	3.717	13MHHM300
4"	300	150	4.820	13MHHM400
5"	225	100	5.820	13MHHM500
6"	150	75	6.695	13MHHM600
8"	100	50	8.695	13MHHM800

* wing nut tightened to 25 in. lb. of torque

Single Pin Heavy Duty Clamps with Serrated Wing Nut - 13MHHM***SN

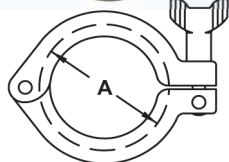

Tube OD	Service Pressure Rating @ 70°F *	Service Pressure Rating @ 250°F *	A	Part Number
½" - ¾"	1500	1200	1.062	13MHHM50-75SN
1" - 1½"	500	300	2.122	13MHHM100-150SN
2"	450	250	2.654	13MHHM200SN
2½"	400	200	3.185	13MHHM250SN
3"	350	175	3.717	13MHHM300SN
4"	300	150	4.820	13MHHM400SN
5"	225	100	5.820	13MHHM500SN
6"	150	75	6.695	13MHHM600SN
8"	100	50	8.695	13MHHM800SN

* wing nut tightened to 25 in. lb. of torque

Double Pin Heavy Duty Clamps - 13MHHM-DP



Tube OD	Service Pressure Rating @ 70°F *	Service Pressure Rating @ 250°F *	A	Part Number
1" - 1½"	500	300	2.122	13MHHM-DP100150
2"	450	250	2.654	13MHHM-DP200
2½"	400	200	3.185	13MHHM-DP250
3"	350	175	3.717	13MHHM-DP300
4"	300	150	4.820	13MHHM-DP400
10"	100	50	10.740	13MHHM-DP1000

* wing nut tightened to 25 in. lb. of torque

Clamps

Three Segment Clamps - 13MHHM-3P

Tube OD	Service Pressure Rating @ 70°F *	Service Pressure Rating @ 250°F *	A	Part Number
1" - 1½"	600	300	2.122	13MHHM-3P100150
2"	550	275	2.654	13MHHM-3P200
2½"	450	225	3.185	13MHHM-3P250
3"	350	175	3.717	13MHHM-3P300
4"	300	150	4.820	13MHHM-3P400
12"	75	50	12.740	13MHHM-3P1200

* wing nut tightened to 25 in. lb. of torque

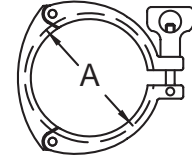

Bolted Clamps - 13MHP

Tube OD	Service Pressure Rating @ 70°F *	Service Pressure Rating @ 250°F *	A	Part Number
½" - ¾"	1500	1200	1.062	13MHP75 **
1" - 1½"	1500	1200	2.046	13MHP100-150
2"	1000	800	2.578	13MHP200
2½"	1000	800	3.110	13MHP250
3"	1000	800	3.640	13MHP300
4"	800	600	4.744	13MHP400
6"	300	200	6.632	13MHP600
8"	250	150	8.638	13MHP800
10"	200	125	10.740	13MHP1000 **
12"	150	100	12.740	13MHP1200 **

* bronze nuts tightened to 20 ft. lb. of torque

** nuts are brass

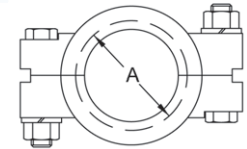

T-bolt Clamps - 13MO

• nuts are brass

Tube OD	Service Pressure Rating @ 70°F *	Service Pressure Rating @ 250°F *	A	304 Stainless Steel Part Number
1" - 1½"	500	250	2.080	13MO100-150
2"	350	200	2.610	13MO200
2½"	300	150	3.140	13MO250
3"	200	100	3.670	13MO300
4"	100	75	4.780	13MO400
6"	75	50	6.690	13MO600
* 8"	50	40	8.690	13MO800
* 10"	40	30	10.690	13MO1000
* 12"	30	25	12.690	13MO1200

* 2 bolt configuration

1" - 3" nuts tightened to 20 in. lb., 4" to 30 in. lb., 6" to 40 in. lb. and 8" - 12" 50 in. lb. of torque.

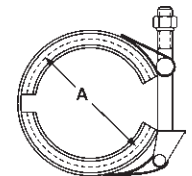

Toggle Clamps - 13MHLA

Tube OD	Service Pressure Rating @ 70°F *	Service Pressure Rating @ 250°F *	A	304 Stainless Steel Part Number
1" - 1½"	150	125	2.122	13MHLA100-150
2"	150	125	2.654	13MHLA200
2½"	150	125	3.185	13MHLA250
3"	150	125	3.717	13MHLA300
4"	100	75	4.820	13MHLA400

* screw tightened to maximum

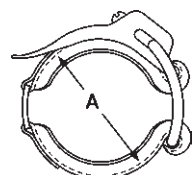

Clamps

Dairy Clamps - 13WGC

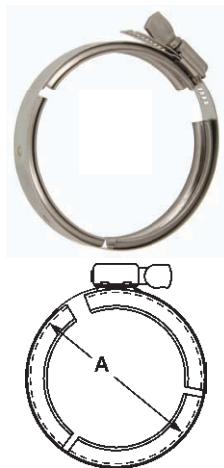

Tube OD	Service Pressure Rating @ 70°F *	Service Pressure Rating @ 250°F *	A	304 Stainless Steel Part Number
1" - 1½"	100	75	2.080	13WGC100-150
2"	100	75	2.610	13WGC200
2½"	100	75	3.140	13WGC250
3"	100	75	3.670	13WGC300
4"	100	75	4.780	13WGC400

* finger tight

Spring Loaded Nut - 13SLN

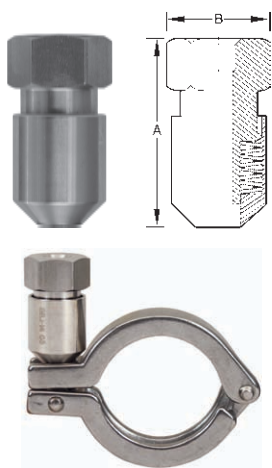

- Lines using PTFE gaskets that are subject to large temperature swings can benefit from this special product. As the PTFE is compressed through the cycling of the lines, the spring load will help keep the connection from leaking.
- If the lines suffer from vibration and bolted clamps are not an option, refitting single pin clamps with this nut will keep the connections from leaking for a longer time than the standard wing nuts.
- If you transport material in tanks via truck, the vibrations can loosen the standard single pin clamps. Spring loaded nuts can add a level of insurance to the shipment.
- *Note:* can be used on all wing nut style clamps

Thread	A	B	304 Stainless Steel Part Number
5/16 - 18	1.73	.875	13SLN

* torque to 50 in. lb.

Torque-Rite® Nuts - 13TR



- an audible "click" indicating correct inch/pounds force
- maintains constant 30 or 50 inch/pounds force
- manual override feature
- retrofits all sanitary clamps, ¾" through 12"
- works in rupture disk applications
- no torque wrench or special training required

Description	Part Number
Torque-Rite® 30 in. lb nut	13TR-30
Torque-Rite® 50 in. lb nut	13TR-50

Accessories



Description	Part Number
Cross hole wing nut 5/16"-18	13WNX
Mini cross hole wing nut 5/16"-18 for ½" - ¾" clamps	13WNXM
Serrated wing nut 5/16"-18	13WNS
Hex wing nut 5/16"-18	13WNH
Bronze hex nut 3/8"-16 for bolted clamps	13BN
Brass 3/8-16 nuts used on 10" & 12" bolted clamps	13BHN
Stainless steel hex nut for bolted clamps	13SN
Bolt 3/8"-16 x 2¼" for 1½" bolted clamps	13CB-2.25
Bolt 3/8"-16 x 2¾" for 2" and 2½" bolted clamps	13CB-2.75
Bolt 3/8"-16 x 3¼" for 3" - 12" bolted clamps	13CB-3.25
Rivet pin for ½" - 5" single pin clamps 5/16" x 1"	13RP
Rivet pin for 6" and 8" single pin clamps 5/16" x 1-1/8"	13RP6
5/16"-18 x 2" threaded eye bolt for ½" - 5" clamps	13IB
5/16"-18 x 2½" threaded eye bolt for 6" - 12" clamps	13IB6

Clamp Ferrules

Short Weld Ferrules - 14WMP

Tube OD	A	B	C	304 Stainless Steel Part Number	316L Stainless Steel Part Number
½"	.500	.370	.500	14WMP-G50	14WMP-R50
¾"	.500	.620	.750	14WMP-G75	14WMP-R75
1"	.500	.870	1.000	14WMP-G100	14WMP-R100
1½"	.500	1.370	1.500	14WMP-G150	14WMP-R150
2"	.500	1.870	2.000	14WMP-G200	14WMP-R200
2½"	.500	2.370	2.500	14WMP-G250	14WMP-R250
3"	.500	2.870	3.000	14WMP-G300	14WMP-R300
4"	.625	3.834	4.000	14WMP-G400	14WMP-R400
5"	.750	4.782	5.000	14WMP-G500	14WMP-R500
6"	.875	5.782	6.000	14WMP-G600	14WMP-R600
8"	.875	7.760	8.000	14WMP-G800	14WMP-R800
10"	.875	9.782	10.000	14WMP-G1000	14WMP-R1000
12"	.875	11.760	12.000	14WMP-G1200	14WMP-R1200

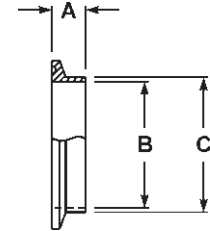

Long Weld Ferrules - L14AM7

Tube OD	A	B	C	304 Stainless Steel Part Number	316L Stainless Steel Part Number
½"	1.125	.370	.500	L14AM7-G50	L14AM7-R50
¾"	1.125	.620	.750	L14AM7-G75	L14AM7-R75
1"	1.125	.870	1.000	L14AM7-G100	L14AM7-R100
1½"	1.125	1.370	1.500	L14AM7-G150	L14AM7-R150
2"	1.125	1.870	2.000	L14AM7-G200	L14AM7-R200
2½"	1.125	2.370	2.500	L14AM7-G250	L14AM7-R250
3"	1.125	2.870	3.000	L14AM7-G300	L14AM7-R300
4"	1.125	3.834	4.000	L14AM7-G400	L14AM7-R400
5"	1.125	4.782	5.000	L14AM7-G500	L14AM7-R500
6"	1.500	5.782	6.000	L14AM7-G600	L14AM7-R600
8"	1.500	7.760	8.000	L14AM7-G800	L14AM7-R800
10"	1.750	9.782	10.000	L14AM7-G1000	L14AM7-R1000
12"	1.750	11.760	12.000	L14AM7-G1200	L14AM7-R1200

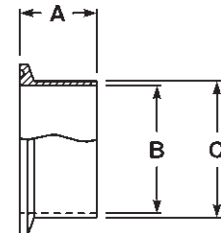

Reducing Roll-on Ferrules - B31RMP

- for expanding

Clamp End	Tube OD	A	B	C	304 Stainless Steel Part Number
1½"	1"	.750	1.007	1.160	B31RMP-G150100
2"	1"	.750	1.007	1.160	B31RMP-G200100
2"	1½"	1.125	1.507	1.676	B31RMP-G200150

* for use when modifying or repairing existing on-site farm milk handling systems

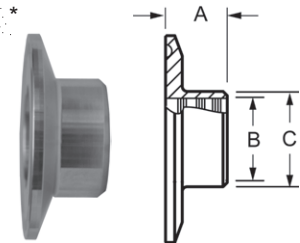

Reducing Ferrules - B31WMP

Tube OD	A	B	C	304 Stainless Steel Part Number	316L Stainless Steel Part Number
2" x 1"	.500	.870	1.000	B31WMP-G200100	B31WMP-R200100
2½" x 1½"	.500	1.370	1.500	B31WMP-G250150	B31WMP-R250150
2½" x 2"	.500	1.870	2.000	B31WMP-G250200	B31WMP-R250200
3" x 2"	.500	1.870	2.000	B31WMP-G300200	B31WMP-R300200
3" x 2½"	.500	2.370	2.500	B31WMP-G300250	B31WMP-R300250
4" x 3"	.625	2.870	3.000	B31WMP-G400300	B31WMP-R400300

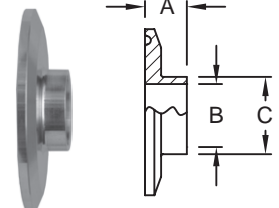

Clamp Ferrules

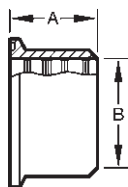

3 * **Roll-On Ferrules - 14RMP**

- for expanding

Tube OD	A	B	304 Stainless Steel Part Number	316L Stainless Steel Part Number
1"	.750	1.005	14RMP-G100	14RMP-R100
1½"	1.125	1.505	14RMP-G150	14RMP-R150
2"	1.312	2.005	14RMP-G200	14RMP-R200
2½"	1.375	2.505	14RMP-G250	14RMP-R250
3"	1.437	3.005	14RMP-G300	14RMP-R300
4"	1.500	4.005	14RMP-G400	14RMP-R400
6"	2.000	6.005	14RMP-G600	---

* for use when modifying or repairing existing on-site farm milk handling systems

3 **Automatic Weld Ferrules - TL14AM7**

- meets ASME BPE-2009 specifications

Tube OD	A	B	C	316L Stainless Steel Part Number
½"	1.750	.370	.500	TL14AM7-50PL
¾"	1.750	.620	.750	TL14AM7-75PL
1"	1.750	.870	1.000	TL14AM7-100PL
1½"	1.750	1.370	1.500	TL14AM7-150PL
2"	2.250	1.870	2.000	TL14AM7-200PL
2½"	2.250	2.370	2.500	TL14AM7-250PL
3"	2.250	2.870	3.000	TL14AM7-300PL
4"	2.250	3.834	4.000	TL14AM7-400PL
6"	3.000	5.782	6.000	New TL14AM7-600PL

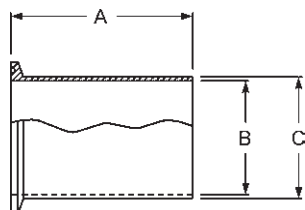

3 **Tank Ferrules (light duty) - 14WLMP**

Tube OD	A	B	C	304 Stainless Steel Part Number	316L Stainless Steel Part Number
1"	3.000	.870	1.000	14WLMP-G100	14WLMP-R100
1½"	3.000	1.370	1.500	14WLMP-G150	14WLMP-R150
2"	3.000	1.870	2.000	14WLMP-G200	14WLMP-R200
2½"	3.000	2.370	2.500	14WLMP-G250	14WLMP-R250
3"	4.000	2.870	3.000	14WLMP-G300	14WLMP-R300
4"	4.000	3.834	4.000	14WLMP-G400	14WLMP-R400
6"	6.000	5.782	6.000	14WLMP-G600	14WLMP-R600
8"	6.000	7.760	8.000	---	14WLMP-R800
10"	6.000	9.782	10.000	---	14WLMP-R1000
12"	6.000	11.760	12.000	---	14WLMP-R1200

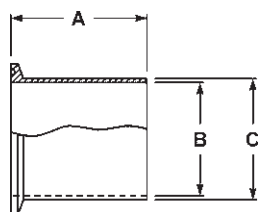

3 **Tank Ferrules (heavy duty) - 14MPW**

- certified ASME materials

Tube OD	A	B	C	316L Stainless Steel Part Number
½"	1.625	.321	.502	14MPW-R50
¾"	1.625	.574	.750	14MPW-R75
1"	1.625	.870	1.160	14MPW-R100
1½"	1.625	1.370	1.676	14MPW-R150
2"	1.750	1.870	2.192	14MPW-R200
2½"	1.750	2.370	2.708	14MPW-R250
3"	1.813	2.870	3.224	14MPW-R300
4"	2.125	3.834	4.256	14MPW-R400
6"	2.500	5.758	6.192	14MPW-R600
8"	2.500	7.758	8.192	14MPW-R800

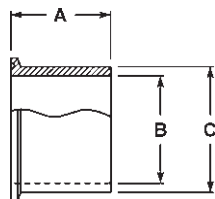

Clamp Caps

Solid End Caps - 16AMP

Tube OD	A	B	304 Stainless Steel Part Number	316L Stainless Steel Part Number
1/2" - 3/4"	.187	.992	16AMP-G50-75	16AMP-R50-75
1" - 1 1/2"	.250	1.984	16AMP-G100-150	16AMP-R100-150
2"	.250	2.516	16AMP-G200	16AMP-R200
2 1/2"	.250	3.047	16AMP-G250	16AMP-R250
3"	.250	3.579	16AMP-G300	16AMP-R300
4"	.312	4.682	16AMP-G400	16AMP-R400
5"	.312	5.687	16AMP-G500	16AMP-R500
6"	.437	6.570	16AMP-G600	16AMP-R600
8"	.437	8.570	16AMP-G800	16AMP-R800
10"	.437	10.570	16AMP-G1000	16AMP-R1000
12"	.437	12.570	16AMP-G1200	16AMP-R1200

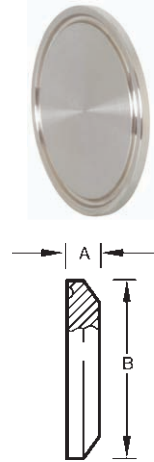

Thermometer Caps - B23BMP

Tube OD	A	B	C*	304 Stainless Steel Part Number	316L Stainless Steel Part Number
1/2"	.500	.993	1/4 NPT	---	B23BMP-R5014
3/4"	.500	.993	1/4 NPT	---	B23BMP-R7514
1"	.625	1.984	1/2 NPT	B23BMP-G100	B23BMP-R100
1 1/2"	.625	1.984	3/4 NPT	B23BMP-G150	B23BMP-R150
2"	.625	2.516	3/4 NPT	B23BMP-G200	B23BMP-R200
2 1/2"	.625	3.047	3/4 NPT	B23BMP-G250	B23BMP-R250
3"	.625	3.579	3/4 NPT	B23BMP-G300	B23BMP-R300
4"	.625	4.682	3/4 NPT	B23BMP-G400	B23BMP-R400

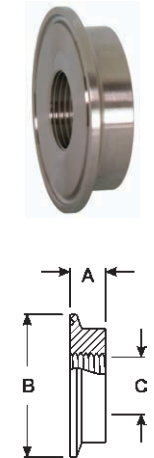

* Other NPT tap sizes available, call Dixon Sanitary

Clamp Adapters

3 Clamp x Plain Bevel Seat Adapters with Hex Nut - 17MP-14

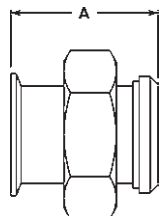

- hex nut is CF8 (304) stainless

Tube OD	A	304 Stainless Steel Part Number
1"	3.000	17MP-14-G100
1½"	3.000	17MP-14-G150
2"	3.000	17MP-14-G200
2½"	3.500	17MP-14-G250
3"	3.750	17MP-14-G300
4"	4.000	17MP-14-G400

3 Clamp x Threaded Bevel Seat Adapters - 17MP-15

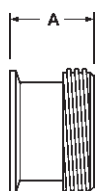

Tube OD	A	304 Stainless Steel Part Number
1"	1.843	17MP-15-G100
1½"	1.843	17MP-15-G150
2"	1.875	17MP-15-G200
2½"	2.000	17MP-15-G250
3"	2.031	17MP-15-G300
4"	2.156	17MP-15-G400

Tygon® Hose Adapters - 14MPHT

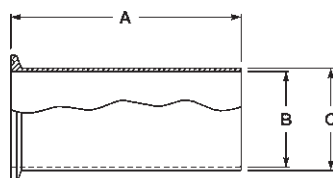

Tube OD	A	B	C	316L Stainless Steel Part Number
½"	4.000	.370	.500	14MPHT-R50
¾"	4.000	.620	.750	14MPHT-R75
1"	4.500	.870	1.000	14MPHT-R100
1½"	4.500	1.370	1.500	14MPHT-R150
2"	4.500	1.870	2.000	14MPHT-R200
2½"	4.500	2.370	2.500	14MPHT-R250
3"	4.500	2.870	3.000	14MPHT-R300
4"	4.625	3.834	4.000	14MPHT-R400
6"	6.000	5.782	6.000	14MPHT-R600

Clamp Adapters

Rubber Hose Adapters - 14MPHR

Tube OD	Hose Size	A	B	304 Stainless Steel Part Number	316L Stainless Steel Part Number
1/2"	1/8"	1.250	.125	---	14MPHR-R50125
1/2"	1/4"	1.500	.250	---	14MPHR-R5025
1/2"	3/8"	1.500	.375	---	14MPHR-R50375
1/2"	1/2"	1.500	.500	---	14MPHR-R50
1/2"	3/4"	1.500	.750	---	14MPHR-R5075
3/4"	1/8"	1.500	.125	---	14MPHR-R75125
3/4"	1/4"	1.500	.250	---	14MPHR-R7525
3/4"	3/8"	1.500	.375	---	14MPHR-R75375
3/4"	1/2"	1.500	.500	---	14MPHR-R7550
3/4"	3/4"	1.500	.750	---	14MPHR-R75
1"	3/8"	1.500	.375	14MPHR-G100375	14MPHR-R100375
1"	1/2"	1.500	.500	14MPHR-G10050	14MPHR-R10050
1"	3/4"	1.688	.750	14MPHR-G10075	14MPHR-R10075
1"	1"	1.688	1.000	14MPHR-G100	14MPHR-R100
1 1/2"	1/8"	1.500	.125	14MPHR-G150125	14MPHR-R150125
1 1/2"	1/4"	1.500	.250	---	14MPHR-R15025
1 1/2"	3/8"	1.500	.375	14MPHR-G150375	14MPHR-R150375
1 1/2"	1/2"	1.500	.500	14MPHR-G15050	14MPHR-R15050
1 1/2"	5/8"	1.500	.625	14MPHR-G150625	14MPHR-R150625
1 1/2"	3/4"	1.500	.750	14MPHR-G15075	14MPHR-R15075
1 1/2"	1"	1.687	1.000	14MPHR-G150100	14MPHR-R150100
1 1/2"	1-1/4"	1.689	1.250	14MPHR-G150-125	14MPHR-R150-125
1 1/2"	1-1/2"	1.687	1.500	14MPHR-G150	14MPHR-R150
2"	1-1/2"	2.312	1.500	14MPHR-G200150	14MPHR-R200150
2"	2"	2.312	2.000	14MPHR-G200	14MPHR-R200
2 1/2"	2-1/2"	2.344	2.500	14MPHR-G250	14MPHR-R250
3"	3"	3.094	3.000	14MPHR-G300	14MPHR-R300
4"	4"	3.406	4.000	14MPHR-G400	14MPHR-R400
6"	6"	3.406	6.000	14MPHR-G600	14MPHR-R600
8"	8"	3.406	8.000	14MPHR-G800	14MPHR-R800

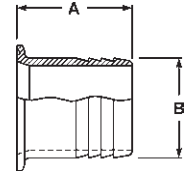

Brewery Hose Barb Adapters - 14MPHRL

- suitable for use with band clamps

Size	A	B	304 Stainless Steel Part Number
1"	3.500	1.045	14MPHRL100
1 1/2"	5.000	1.545	14MPHRL150
2"	5.000	2.045	14MPHRL200
2 1/2"	5.500	2.545	14MPHRL250
3"	5.500	3.045	14MPHRL300
4"	5.500	4.045	14MPHRL400

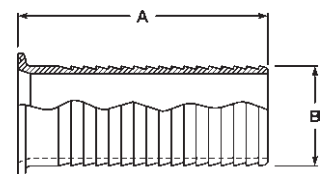

CAUTION

Use of PVC tubing requires special techniques to prevent leakage. All assembly work must be done with heated tube. Cold durometer is 90 as opposed to rubber hose at 65 to 70 durometer. Banding buckles must be at 180° from one another.

Clamp Adapters

Male NPT Adapters - 21MP

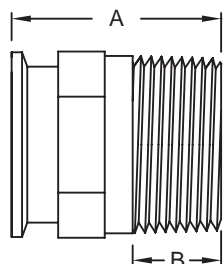

Tube OD	NPT Size	A	B	304 Stainless Steel Part Number	316L Stainless Steel Part Number
1/2"	1/8"	2.000	.392	---	21MP-R50125
1/2"	1/4"	2.000	.595	---	21MP-R5025
1/2"	3/8"	2.000	.600	---	21MP-R50375
1/2"	1/2"	1.625	.782	---	21MP-R50
1/2"	3/4"	2.000	.794	---	21MP-R5075
3/4"	1/4"	2.000	.595	---	21MP-R7525
3/4"	3/8"	2.000	.600	---	21MP-R75375
3/4"	1/2"	2.000	.782	---	21MP-R7550
3/4"	3/4"	1.787	.794	---	21MP-R75
3/4"	1"	2.250	.985	---	21MP-R75100
1"	1/8"	2.187	.392	21MP-G100-125	21MP-R100-125
1"	1/4"	2.161	.595	21MP-G10025	21MP-R10025
1"	3/8"	2.187	.600	21MP-G100375	21MP-R100375
1"	1/2"	2.187	.782	21MP-G10050	21MP-R10050
1"	3/4"	2.187	.794	21MP-G10075	21MP-R10075
1"	1"	2.250	.985	21MP-G100	21MP-R100
1"	1-1/4"	2.438	1.009	21MP-G100125	21MP-R100125
1"	1-1/2"	2.438	1.025	21MP-G100150	21MP-R100150
1"	2"	2.625	1.058	21MP-G100200	21MP-R100200
1 1/2"	1/8"	2.187	.392	21MP-G150-125	21MP-R150-125
1 1/2"	1/4"	2.161	.595	21MP-G15025	21MP-R15025
1 1/2"	3/8"	2.187	.600	21MP-G150375	21MP-R150375
1 1/2"	1/2"	2.187	.782	21MP-G15050	21MP-R15050
1 1/2"	3/4"	2.187	.794	21MP-G15075	21MP-R15075
1 1/2"	1"	2.437	.985	21MP-G150100	21MP-R150100
1 1/2"	1-1/4"	2.438	1.009	21MP-G150125	21MP-R150125
1 1/2"	1-1/2"	2.250	1.025	21MP-G150	21MP-R150
1 1/2"	2"	2.625	1.058	21MP-G150200	21MP-R150200
1 1/2"	2-1/2"	3.281	1.571	21MP-G150250	21MP-R150250
2"	1/4"	2.469	1.009	21MP-G200125	21MP-R200125
2"	1/2"	2.188	.782	21MP-G20050	21MP-R20050
2"	3/4"	2.188	.794	21MP-G20075	21MP-R20075
2"	1"	2.469	.985	21MP-G200100	21MP-R200100
2"	1-1/2"	2.625	1.009	21MP-G200150	21MP-R200150
2"	2"	2.638	1.058	21MP-G200	21MP-R200
2"	2-1/2"	3.125	1.571	21MP-G200250	21MP-R200250
2"	3"	3.500	1.634	21MP-G200300	21MP-R200300
2"	4"	3.500	1.734	21MP-G200400	21MP-R200400
2 1/2"	1/2"	2.781	.782	21MP-G25050	21MP-R25050
2 1/2"	1"	2.781	.782	21MP-G250100	21MP-R250100
2 1/2"	1-1/2"	2.781	1.025	21MP-G250150	21MP-R250150
2 1/2"	2"	2.781	1.058	21MP-G250200	21MP-R250200
2 1/2"	2-1/2"	2.875	1.571	21MP-G250	21MP-R250
2 1/2"	3"	3.690	1.634	21MP-G250300	21MP-R250300
3"	1"	3.000	.985	21MP-G300100	21MP-R300100
3"	1-1/2"	3.000	1.009	21MP-G300150	21MP-R300150
3"	2"	3.000	1.058	21MP-G300200	21MP-R300200
3"	2-1/2"	3.000	1.571	21MP-G300250	21MP-R300250
3"	3"	3.070	1.634	21MP-G300	21MP-R300
3"	4"	3.500	1.734	21MP-G300400	21MP-R300400
4"	3"	3.813	1.634	21MP-G400300	21MP-R400300
4"	4"	3.155	1.734	21MP-G400	21MP-R400
6"	6"	4.500	1.946	21MP-G600	21MP-R600

• see pages 222-223 for Pipe Thread data

Clamp Adapters

Female NPT Adapters - 22MP

Tube OD	NPT Size	A	304 Stainless Steel Part Number	316L Stainless Steel Part Number
1/2"	1/8"	1.250	---	22MP-R50-125
1/2"	1/4"	1.500	---	22MP-R5025
1/2"	3/8"	1.500	---	22MP-R50375
1/2"	1/2"	1.500	---	22MP-R50
1/2"	3/4"	1.500	---	22MP-R5075
1/2"	1"	1.625	---	22MP-R50100
1/2"	1-1/2"	2.250	---	22MP-R50150
1/2"	2"	2.250	---	22MP-R50200
3/4"	1/8"	1.250	---	22MP-R75125
3/4"	1/4"	1.500	---	22MP-R7525
3/4"	3/8"	1.500	---	22MP-R75375
3/4"	1/2"	1.625	---	22MP-R7550
3/4"	3/4"	1.625	---	22MP-R75
3/4"	1"	1.625	---	22MP-R75100
1"	1/8"	3.281	22MP-G100-125	22MP-R100-125
1"	1/4"	1.625	22MP-G10025	22MP-R10025
1"	3/8"	1.625	22MP-G100375	22MP-R100375
1"	1/2"	1.625	22MP-G10050	22MP-R10050
1"	3/4"	1.625	22MP-G10075	22MP-R10075
1"	1"	1.625	22MP-G100	22MP-R100
1"	1-1/4"	1.625	22MP-G100125	22MP-R100125
1"	1-1/2"	1.625	22MP-G100150	22MP-R100150
1"	2"	2.500	22MP-G100200	22MP-R100200
1 1/2"	1/8"	2.500	22MP-G150-125	22MP-R150-125
1 1/2"	1/4"	1.625	22MP-G15025	22MP-R15025
1 1/2"	3/8"	1.625	22MP-G150375	22MP-R150375
1 1/2"	1/2"	1.625	22MP-G15050	22MP-R15050
1 1/2"	3/4"	1.625	22MP-G15075	22MP-R15075
1 1/2"	1"	2.250	22MP-G150100	22MP-R150100
1 1/2"	1-1/4"	2.250	22MP-G150125	22MP-R150125
1 1/2"	1-1/2"	2.250	22MP-G150	22MP-R150
1 1/2"	2"	2.500	22MP-G150200	22MP-R150200
1 1/2"	2-1/2"	2.500	22MP-G150250	22MP-R150250
1 1/2"	3"	2.500	22MP-G150300	22MP-R150300
2"	1/4"	1.687	22MP-G20025	22MP-R20025
2"	1/2"	1.687	22MP-G20050	22MP-R20050
2"	3/4"	1.687	22MP-G20075	22MP-R20075
2"	1"	1.687	22MP-G200100	22MP-R200100
2"	1-1/4"	1.656	22MP-G200125	22MP-R200125
2"	1-1/2"	2.344	22MP-G200150	22MP-R200150
2"	2"	2.406	22MP-G200	22MP-R200
2"	2-1/2"	2.406	22MP-G200250	22MP-R200250
2"	3"	2.406	22MP-G200300	22MP-R200300
2"	4"	2.406	22MP-G200400	---
2 1/2"	3/4"	1.313	22MP-G25075	22MP-R25075
2 1/2"	1"	1.313	22MP-G250100	22MP-R250100
2 1/2"	1-1/2"	1.656	22MP-G250150	22MP-R250150
2 1/2"	2"	2.093	22MP-G250200	22MP-R250200
2 1/2"	2-1/2"	2.187	22MP-G250	22MP-R250
2 1/2"	3"	2.187	22MP-G250300	22MP-R250300
3"	1"	2.187	22MP-G300100	22MP-R300100
3"	1-1/2"	2.187	22MP-G300150	22MP-R300150
3"	2"	2.187	22MP-G300200	22MP-R300200
3"	2-1/2"	2.187	22MP-G300250	22MP-R300250
3"	3"	2.187	22MP-G300	22MP-R300
4"	1-1/2"	2.187	22MP-G400150	22MP-R400150
4"	2"	2.187	22MP-G400200	22MP-R400200
4"	2-1/2"	2.187	22MP-G400250	22MP-R400250
4"	3"	2.187	22MP-G400300	22MP-R400300
4"	4"	3.652	22MP-G400	22MP-R400
4"	6"	3.250	22MP-G400600	22MP-R400600

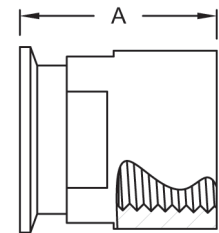

• see pages 222-223 for Pipe Thread data

Clamp Elbows

3 90° Clamp Elbows - B2CMP

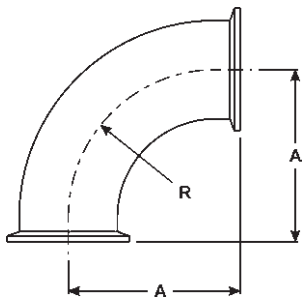

Tube OD	A	R	304 Stainless Steel Part Number	316L Stainless Steel Part Number
1/2"	1.625	1.125	---	B2CMP-R50
3/4"	1.625	1.125	---	B2CMP-R75
1/2"	3.500	1.125	---	B2CMPL-R50
3/4"	3.500	1.125	---	B2CMPL-R75
1"	2.000	1.500	B2CMP-G100	B2CMP-R100
1 1/2"	2.750	2.250	B2CMP-G150	B2CMP-R150
2"	3.500	3.000	B2CMP-G200	B2CMP-R200
2 1/2"	4.250	3.750	B2CMP-G250	B2CMP-R250
3"	5.000	4.500	B2CMP-G300	B2CMP-R300
4"	6.625	6.000	B2CMP-G400	B2CMP-R400
6"	9.875	9.000	B2CMP-G600	B2CMP-R600
8"	12.875	12.000	B2CMP-G800	B2CMP-R800
10"	15.875	15.000	B2CMP-G1000	---
12"	18.875	18.000	B2CMP-G1200	---

Clamp Elbows

90° Non-Tapered Reducing Clamp Elbows - B2CM31MP

Tube OD	A	B	304 Stainless Steel Part Number	316L Stainless Steel Part Number
2" x 1½"	2.750	2.750	B2CM31MPG200150	B2CM31MPR200150
2½" x 2"	3.500	3.500	B2CM31MPG250200	B2CM31MPR250200
3" x 2"	3.500	3.500	B2CM31MPG300200	B2CM31MPR300200
3" x 2½"	4.250	4.250	B2CM31MPG300250	B2CM31MPR300250

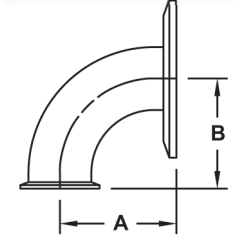

45° Clamp Elbows - B2KMP

Tube OD	A	R	304 Stainless Steel Part Number	316L Stainless Steel Part Number
½"	.966	1.125	---	B2KMP-R50
¾"	.966	1.125	---	B2KMP-R75
1"	1.125	1.500	B2KMP-G100	B2KMP-R100
1½"	1.437	2.250	B2KMP-G150	B2KMP-R150
2"	1.750	3.000	B2KMP-G200	B2KMP-R200
2½"	2.062	3.750	B2KMP-G250	B2KMP-R250
3"	2.375	4.500	B2KMP-G300	B2KMP-R300
4"	3.125	6.000	B2KMP-G400	B2KMP-R400
6"	4.625	9.000	B2KMP-G600	B2KMP-R600
8"	5.875	12.000	B2KMP-G800	B2KMP-R800
10"	7.125	15.000	B2KMP-G1000	---
12"	8.375	18.000	B2KMP-G1200	---

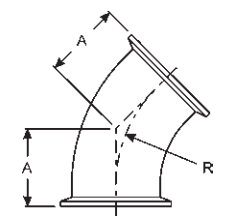

90° Clamp by Plain Bevel Seat with Hex Nut Elbows - B2FMP-14

- Hex nut is CF8 (304 stainless)

Tube OD	A	B	304 Stainless Steel Part Number
1"	2.218	2.000	B2FMP-14-G100
1½"	2.968	2.750	B2FMP-14-G150
2"	3.750	3.500	B2FMP-14-G200
2½"	4.625	4.250	B2FMP-14-G250
3"	5.406	5.000	B2FMP-14-G300
4"	7.031	6.625	B2FMP-14-G400

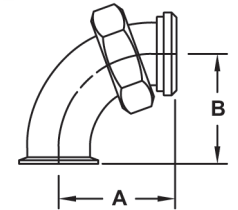

Other types of elbows available call Dixon Sanitary for information



B2CMP-14



B2FMP-15



B2SXLMP
various radii

Clamp Tees

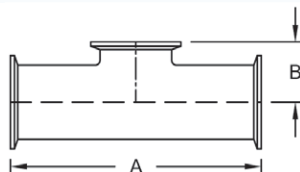

3 Short Outlet Tees - B7MPS

Tube OD	A	B	304 Stainless Steel Part Number	316L Stainless Steel Part Number
1"	4.750	1.125	B7MPS-G100	B7MPS-R100
1½"	5.500	1.375	B7MPS-G150	B7MPS-R150
2"	7.000	1.625	B7MPS-G200	B7MPS-R200
2½"	7.000	1.875	B7MPS-G250	B7MPS-R250
3"	7.500	2.125	B7MPS-G300	B7MPS-R300
4"	9.000	2.750	B7MPS-G400	B7MPS-R400

3 Clamp Tees - B7MP

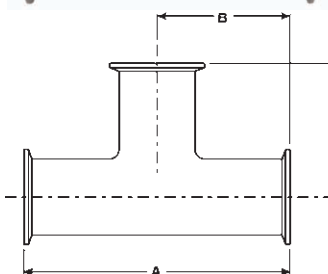

Tube OD	A	B	304 Stainless Steel Part Number	316L Stainless Steel Part Number
½"	4.750	2.375	---	B7MP-R50
¾"	5.000	2.500	---	B7MP-R75
1"	4.750	2.375	B7MP-G100	B7MP-R100
1½"	5.500	2.750	B7MP-G150	B7MP-R150
2"	7.000	3.500	B7MP-G200	B7MP-R200
2½"	7.000	3.500	B7MP-G250	B7MP-R250
3"	7.500	3.750	B7MP-G300	B7MP-R300
4"	9.000	4.500	B7MP-G400	B7MP-R400
6"	13.000	6.500	B7MP-G600	B7MP-R600
8"	15.750	7.875	B7MP-G800	B7MP-R800
10"	18.750	9.735	B7MP-G1000	---
12"	21.750	10.735	B7MP-G1200	---

3 Clamp Reducing Tees - B7RMP

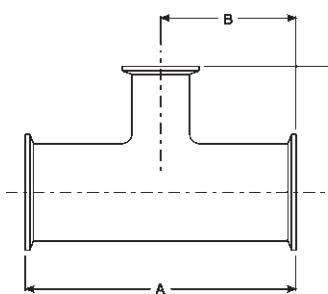

Tube OD	A	B	C	304 Stainless Steel Part Number	316L Stainless Steel Part Number
¾" x ½"	5.000	2.500	2.500	---	B7RMP-R7550
1" x ½"	5.250	2.625	2.625	---	B7RMP-R10050
1½" x ½"	5.750	2.875	2.875	---	B7RMP-R15050
1½" x ¾"	5.250	2.875	2.875	---	B7RMP-R15075
1½" x 1"	4.312	2.156	1.875	B7RMP-G150100	B7RMP-R150100
2" x ½"	6.750	3.375	3.125	---	B7RMP-R20050
2" x ¾"	6.750	3.375	3.125	---	B7RMP-R20075
2" x 1"	5.125	2.562	2.125	B7RMP-G200100	B7RMP-R200100
2" x 1½"	5.125	2.562	2.406	B7RMP-G200150	B7RMP-R200150
2½" x 1½"	5.688	2.844	2.656	B7RMP-G250150	B7RMP-R250150
2½" x 2"	5.688	2.844	2.812	B7RMP-G250200	B7RMP-R250200
3" x 1½"	6.188	3.093	2.906	B7RMP-G300150	B7RMP-R300150
3" x 2"	6.188	3.093	3.063	B7RMP-G300200	B7RMP-R300200
3" x 2½"	6.188	3.093	3.093	B7RMP-G300250	B7RMP-R300250
4" x 1½"	8.125	4.063	3.406	B7RMP-G400150	B7RMP-R400150
4" x 2"	8.125	4.063	3.563	B7RMP-G400200	B7RMP-R400200
4" x 2½"	8.125	4.063	3.594	B7RMP-G400250	B7RMP-R400250
4" x 3"	8.125	4.063	3.594	B7RMP-G400300	B7RMP-R400300

Other types of tees available call Dixon Sanitary for information



B7RMP

Clamp Reducers

Clamp Concentric Reducers - B3114MP 3

Tube OD	A	304 Stainless Steel Part Number	316L Stainless Steel Part Number
3/4" x 1/2"	2.000	---	B3114MP-R7550
1" x 1/2"	3.000	---	B3114MP-R10050
1" x 3/4"	2.000	---	B3114MP-R10075
1 1/2" x 1/2"	5.000	---	B3114MP-R15050
1 1/2" x 3/4"	4.000	---	B3114MP-R15075
1 1/2" x 1"	3.000	B3114MP-G150100	B3114MP-R150100
2" x 1/2"	7.000	---	B3114MP-R20050
2" x 3/4"	6.000	---	B3114MP-R20075
2" x 1"	5.000	B3114MP-G200100	B3114MP-R200100
2" x 1 1/2"	3.000	B3114MP-G200150	B3114MP-R200150
2 1/2" x 1 1/2"	5.000	B3114MP-G250150	B3114MP-R250150
2 1/2" x 2"	3.000	B3114MP-G250200	B3114MP-R250200
3" x 1"	9.000	B3114MP-G300100	B3114MP-R300100
3" x 1 1/2"	7.000	B3114MP-G300150	B3114MP-R300150
3" x 2"	5.000	B3114MP-G300200	B3114MP-R300200
3" x 2 1/2"	3.000	B3114MP-G300250	B3114MP-R300250
4" x 1 1/2"	11.125	B3114MP-G400150	B3114MP-R400150
4" x 2"	9.125	B3114MP-G400200	B3114MP-R400200
4" x 2 1/2"	7.125	B3114MP-G400250	B3114MP-R400250
4" x 3"	5.125	B3114MP-G400300	B3114MP-R400300
6" x 2"	6.875	B3114MP-G600200	B3114MP-R600200
6" x 3"	6.875	B3114MP-G600300	B3114MP-R600300
6" x 4"	7.000	B3114MP-G600400	B3114MP-R600400
8" x 4"	7.500	B3114MP-G800400	B3114MP-R800400
8" x 6"	7.750	B3114MP-G800600	B3114MP-R800600

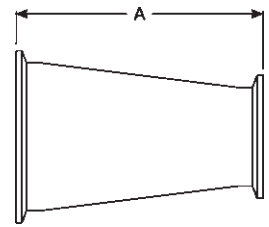

Plain Bevel Seat x Clamp Concentric Reducers - B14C31 3

Tube OD	A	304 Stainless Steel Part Number
1 1/2" x 1"	3.218	B14C31-G150100 *
2" x 1 1/2"	3.250	B14C31-G200150
2 1/2" x 1 1/2"	5.375	B14C31-G250150
2 1/2" x 2"	3.375	B14C31-G250200
3" x 1 1/2"	7.406	B14C31-G300150
3" x 2"	5.406	B14C31-G300200
3" x 2 1/2"	3.406	B14C31-G300250

* comes with 13H-G150, hex nut cannot be assembled on fitting after welding

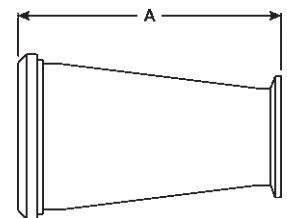

Other types of concentric reducers available call Dixon Sanitary for information

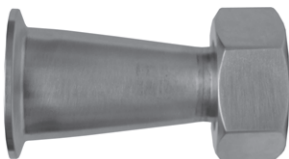

B3114

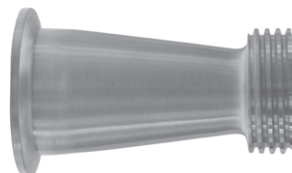

B3115

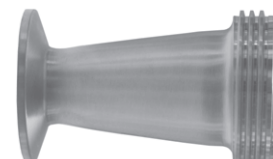

B15C31

Clamp Reducers

3 Clamp Eccentric Reducers - B3214MP

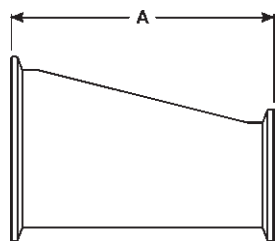

Tube OD	A	304 Stainless Steel Part Number	316L Stainless Steel Part Number
3/4" x 1/2"	2.000	---	B3214MP-R7550
1" x 1/2"	3.000	---	B3214MP-R10050
1" x 3/4"	2.000	---	B3214MP-R10075
1 1/2" x 1/2"	5.000	---	B3214MP-R15050
1 1/2" x 3/4"	4.000	---	B3214MP-R15075
1 1/2" x 1"	3.000	B3214MP-G150100	B3214MP-R150100
2" x 1/2"	7.000	---	B3214MP-R20050
2" X 3/4"	6.000	---	B3214MP-R20075
2" x 1"	5.000	B3214MP-G200100	B3214MP-R200100
2" x 1 1/2"	3.000	B3214MP-G200150	B3214MP-R200150
2 1/2" x 1 1/2"	5.000	B3214MP-G250150	B3214MP-R250150
2 1/2" x 2"	3.000	B3214MP-G250200	B3214MP-R250200
3" x 1"	9.000	B3214MP-G300100	B3214MP-R300100
3" x 1 1/2"	7.000	B3214MP-G300150	B3214MP-R300150
3" x 2"	5.000	B3214MP-G300200	B3214MP-R300200
3" x 2 1/2"	3.000	B3214MP-G300250	B3214MP-R300250
4" x 1 1/2"	11.125	B3214MP-G400150	B3214MP-R400150
4" x 2"	9.125	B3214MP-G400200	B3214MP-R400200
4" x 2 1/2"	7.125	B3214MP-G400250	B3214MP-R400250
4" x 3"	5.125	B3214MP-G400300	B3214MP-R400300
6" x 3"	6.875	B3214MP-G600300	B3214MP-R600300
6" x 4"	7.000	B3214MP-G600400	B3214MP-R600400
8" x 4"	7.500	B3214MP-G800400	B3214MP-R800400
8" x 6"	7.750	B3214MP-G800600	B3214MP-R800600

Other types of eccentric reducers available call Dixon Sanitary for information

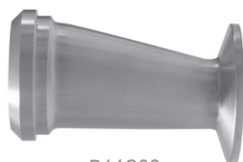

Miscellaneous Clamp Configurations

Spool Assembly - SPOOL

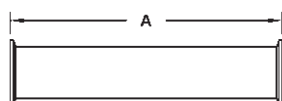

Tube OD	A (minimum length)	304 Stainless Steel Part Number	316L Stainless Steel Part Number
1/2"	2.25	SPOOL *-G050	SPOOL *-R050
3/4"	2.25	SPOOL *-G075	SPOOL *-R075
1"	2.25	SPOOL *-G100	SPOOL *-R100
1 1/2"	2.25	SPOOL *-G150	SPOOL *-R150
2"	2.25	SPOOL *-G200	SPOOL *-R200
2 1/2"	2.25	SPOOL *-G250	SPOOL *-R250
3"	2.25	SPOOL *-G300	SPOOL *-R300
4"	2.25	SPOOL *-G400	SPOOL *-R400
6"	3.00	SPOOL *-G600	SPOOL *-R600

* overall length in inches

Miscellaneous Clamp Configurations

Clamp Laterals - B28AMP 3

Tube OD	A	B	C	316L Stainless Steel Part Number
1"	7.000	1.500	5.500	B28AMP-R100
1½"	8.375	1.688	6.688	B28AMP-R150
2"	9.750	2.125	7.625	B28AMP-R200
2½"	11.000	2.000	9.000	B28AMP-R250
3"	11.750	2.375	9.375	B28AMP-R300
4"	14.062	2.640	11.312	B28AMP-R400

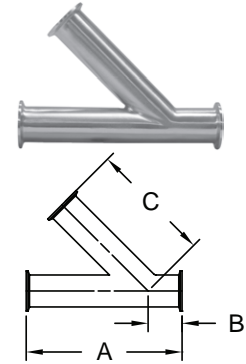

Clamp True Y - B28BMP 3

Tube OD	A	B	316L Stainless Steel Part Number
1"	2.500	2.938	B28BMP-R100
1½"	2.500	2.938	B28BMP-R150
2"	3.125	3.750	B28BMP-R200
2½"	3.870	4.625	B28BMP-R250
3"	4.500	5.375	B28BMP-R300
4"	6.000	6.000	B28BMP-R400

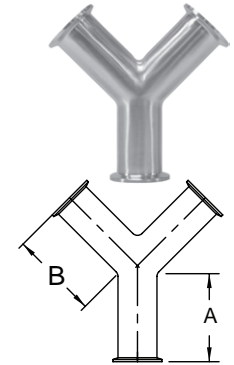

Clamp Cross - B9MP 3

Tube OD	A	B	304 Stainless Steel Part Number	316L Stainless Steel Part Number
1"	4.750	2.375	B9MP-G100	B9MP-R100
1½"	5.500	2.750	B9MP-G150	B9MP-R150
2"	7.000	3.500	B9MP-G200	B9MP-R200
2½"	7.000	3.500	B9MP-G250	B9MP-R250
3"	7.500	3.750	B9MP-G300	B9MP-R300
4"	9.000	4.500	B9MP-G400	B9MP-R400

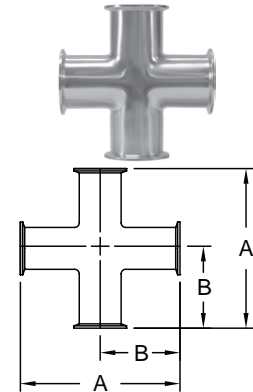

Clamp 180° Return Bends - B2WUMP 3

- bends are 1.5 x tube diameter

Tube OD	A	B	316L Stainless Steel Part Number
1"	3.000	2.500	B2WUMP-R100
1½"	4.500	3.500	B2WUMP-R150
2"	6.000	4.500	B2WUMP-R200
2½"	7.500	5.500	B2WUMP-R250
3"	9.000	6.500	B2WUMP-R300
4"	12.000	8.625	B2WUMP-R400

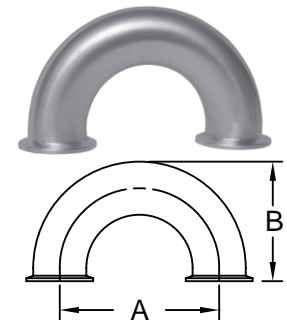

Clamp End Protection Covers - BCC

Size	Part Number
½"	BCC-050
¾"	BCC-075
1"	BCC-100
1½"	BCC-150
2"	BCC-200
2½"	BCC-250
3"	BCC-300
4"	BCC-400
6"	BCC-600
8"	BCC-800

- Use these covers to protect all clamp ends on fittings, valves, filters and pumps.
- vinyl plastic



Clamp Gaskets

Buna-N - Black



Type 1 - Standard
1/2" - 3/4"

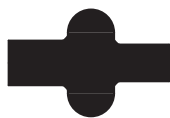

Type 1 - Standard
1" and larger

- color code: red dot
- meets 21CFR 177.2600
- refer to pages 216-218 for compatibility information

Size	Part Number
1/2"	42MP-U50
3/4"	42MP-U75
1"	40MP-U100
1 1/2"	40MP-U150
2"	40MP-U200
2 1/2"	40MP-U250
3"	40MP-U300
4"	40MP-U400
5"	40MP-U500
6"	40MP-U600
8"	40MP-U800

Buna-N - White



Type 1 - Standard
1/2" - 3/4"



Type 1 - Standard
1" and larger

- color code: red dot
- meets 21CFR 177.2600
- refer to pages 216-218 for compatibility information

Size	Part Number
1/2"	42MP-UW50
3/4"	42MP-UW75
1"	40MP-UW100
1 1/2"	40MP-UW150
2"	40MP-UW200
2 1/2"	40MP-UW250
3"	40MP-UW300
4"	40MP-UW400
6"	40MP-UW600

EPDM



Type 1 - Standard
1/2" - 3/4"



Type 1 - Standard
1" and larger

- color code: three green dots
- peroxide cured
- meets 21CFR 177.2600
- passed U.S.P. Class VI Cytotoxicity testing
- refer to pages 216-218 for compatibility information

Size	Part Number
1/2"	42MP-E50
3/4"	42MP-E75
1"	40MP-E100
1 1/2"	40MP-E150
2"	40MP-E200
2 1/2"	40MP-E250
3"	40MP-E300
4"	40MP-E400
5"	40MP-E500
6"	40MP-E600

FKM (Viton®)



Type 1 - Standard
1/2" - 3/4"



Type 1 - Standard
1" and larger

- color code: one white dot and one yellow dot
- peroxide cured
- meets 21CFR 177.2600
- passed U.S.P. Class VI Cytotoxicity testing
- refer to pages 216-218 for compatibility information

Size	Part Number
1/2"	42MP-SFY50
3/4"	42MP-SFY75
1"	40MP-SFY100
1 1/2"	40MP-SFY150
2"	40MP-SFY200
2 1/2"	40MP-SFY250
3"	40MP-SFY300
4"	40MP-SFY400
6"	40MP-SFY600

- see pages 214-215 for sizing charts

Clamp Gaskets

Silicone - White

Size	Part Number
1/2"	42MP-XW50
3/4"	42MP-XW75
1"	40MP-XW100
1 1/2"	40MP-XW150
2"	40MP-XW200
2 1/2"	40MP-XW250
3"	40MP-XW300
4"	40MP-XW400
6"	40MP-XW600



Type 1 - Standard
1/2" - 3/4"



Type 1 - Standard
1" and larger

- color code: pink dot
- peroxide cured
- meets 21CFR 177.2600
- passed U.S.P. Class VI Cytotoxicity testing
- refer to pages 216-218 for compatibility information

Silicone - Clear

Size	Part Number
1/2"	42MP-XC50
3/4"	42MP-XC75
1"	40MP-XC100
1 1/2"	40MP-XC150
2"	40MP-XC200
2 1/2"	40MP-XC250
3"	40MP-XC300
4"	40MP-XC400



Type 1 - Standard
1/2" - 3/4"



Type 1 - Standard
1" and larger

- color code: no dot
- peroxide cured
- meets 21CFR 177.2600
- passed U.S.P. Class VI Cytotoxicity testing
- refer to pages 216-218 for compatibility information

PTFE (Teflon®)

Size	Part Number
1/2"	42MP-G50
3/4"	42MP-G75
1"	40MP-G100
1 1/2"	40MP-G150
2"	40MP-G200
2 1/2"	40MP-G250
3"	40MP-G300
4"	40MP-G400
5"	40MP-G500 New
6"	40MP-G600
8"	40MP-G800
10"	40MP-G1000
12"	40MP-G1200



Type 1 - Standard
1/2" - 3/4"



Type 1 - Standard
1" and larger

- color code: no dot
- meets 21CFR 177.1550
- passed U.S.P. Class VI Cytotoxicity testing
- refer to pages 216-218 for compatibility information
- not recommended for use with bolted clamps

CAUTION

PTFE (Teflon®) is a material subject to plastic flow. When cycled through heat and then cooled down in process lines, PTFE gaskets will not return to the original configuration and it will continue to compress as the cycling continues. This plastic flow will allow leakage if clamp torques are not maintained.

- see pages 214-215 for sizing charts

Clamp Gaskets

Metal Detectable Clamp Gaskets



Type 1 - Standard
1/2" - 3/4"



Type 1 - Standard
1" and larger

Metal detectable gaskets are impregnated with stainless steel particles. The addition of stainless steel allows a gasket or gasket pieces to be found with metal detection equipment.

Buna-N - 40MP-UZ

- minimum temp **-20°F**
- maximum temp **212°F**
- good general use where temperature extremes do not exist

Size	Part Number
1"	40MP-UZ100
1½"	40MP-UZ150
2"	40MP-UZ200
2½"	40MP-UZ250
3"	40MP-UZ300
4"	40MP-UZ400

EPDM - 40MP-EZ

- minimum temp **-70°F**
- maximum temp **310°F**
- excellent base, steam and water resistant

Size	Part Number
1"	40MP-EZ100
1½"	40MP-EZ150
2"	40MP-EZ200
2½"	40MP-EZ250
3"	40MP-EZ300
4"	40MP-EZ400

Viton® - 40MP-SFYZ

- minimum temp **-20°F**
- maximum temp **410°F**
- provides high acid, steam and heat resistant

Size	Part Number
1"	40MP-SFYZ100
1½"	40MP-SFYZ150
2"	40MP-SFYZ200
2½"	40MP-SFYZ250
3"	40MP-SFYZ300
4"	40MP-SFYZ400

- see pages 214-215 for sizing charts

Clamp Flanged Gaskets

Buna-N - Black, Flanged

Size	Part Number
1"	40MPF-U100
1½"	40MPF-U150
2"	40MPF-U200
2½"	40MPF-U250
3"	40MPF-U300
4"	40MPF-U400
6"	40MPF-U600
8"	40MPF-U800
10"	40MPF-U1000
12"	40MPF-U1200

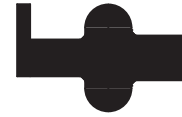

Type 2 - Flanged
1" and larger

- color code: red dot
- meets 21CFR 177.2600
- refer to pages 216-218 for compatibility information
- not recommended for use with bolted clamps

Buna-N - White, Flanged

Size	Part Number
1"	40MPF-UW100
1½"	40MPF-UW150
2"	40MPF-UW200
2½"	40MPF-UW250
3"	40MPF-UW300
4"	40MPF-UW400
6"	40MPF-UW600
8"	40MPF-UW800

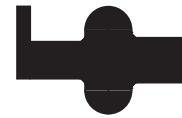

Type 2 - Flanged
1" and larger

- color code: red dot
- meets 21CFR 177.2600
- refer to pages 216-218 for compatibility information
- not recommended for use with bolted clamps

EPDM - Flanged

Size	Part Number
1"	40MPF-E100
1½"	40MPF-E150
2"	40MPF-E200
2½"	40MPF-E250
3"	40MPF-E300
4"	40MPF-E400
6"	40MPF-E600
8"	40MPF-E800
10"	40MPF-E1000
12"	40MPF-E1200



Type 2 - Flanged
1" and larger

- color code: three green dots
- peroxide cured
- meets 21CFR 177.2600
- passed U.S.P. Class VI Cytotoxicity testing
- refer to pages 216-218 for compatibility information
- not recommended for use with bolted clamps

- see pages 214-215 for sizing charts

Clamp Flanged Gaskets

FKM (Viton®) - Flanged



Type 2 - Flanged
1" and larger

- color code: one white dot, one yellow dot
- peroxide cured
- meets 21CFR 177.2600
- passed U.S.P. Class VI Cytotoxicity testing
- refer to pages 216-218 for compatibility information
- not recommended for use with bolted clamps

Size	Part Number
1"	40MPF-SFY100
1½"	40MPF-SFY150
2"	40MPF-SFY200
2½"	40MPF-SFY250
3"	40MPF-SFY300
4"	40MPF-SFY400
6"	40MPF-SFY600
8"	40MPF-SFY800
10"	40MPF-SFY1000
12"	40MPF-SFY1200

Silicone - White, Flanged



Type 2 - Flanged
1" and larger

- color code: pink dot
- peroxide cured
- meets 21CFR 177.2600
- passed U.S.P. Class VI Cytotoxicity testing
- refer to pages 216-218 for compatibility information
- not recommended for use with bolted clamps

Size	Part Number
1"	40MPF-XW100
1½"	40MPF-XW150
2"	40MPF-XW200
2½"	40MPF-XW250
3"	40MPF-XW300
4"	40MPF-XW400
6"	40MPF-XW600
8"	40MPF-XW800
10"	40MPF-XW1000
12"	40MPF-XW1200

Silicone - Clear, Flanged



Type 2 - Flanged
1" and larger

- color code: no dot
- peroxide cured
- meets 21CFR 177.2600
- passed U.S.P. Class VI Cytotoxicity testing
- refer to pages 216-218 for compatibility information
- not recommended for use with bolted clamps

Size	Part Number
1"	40MPF-XC100
1½"	40MPF-XC150
2"	40MPF-XC200
2½"	40MPF-XC250
3"	40MPF-XC300
4"	40MPF-XC400
6"	40MPF-XC600
8"	40MPF-XC800

- see pages 214-215 for sizing charts

Clamp Screened Gaskets

Buna-N - Mesh Screen, 316

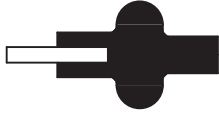

Type 3 - Mesh

Size	Part Number
1"	40MPS-U100
1½"	40MPS-U150
2"	40MPS-U200
2½"	40MPS-U250
3"	40MPS-U300
4"	40MPS-U400

- color code: red dot
- 10 mesh standard, other mesh available, call for details
- meets 21CFR 177.2600
- refer to pages 216-218 for compatibility information
- refer to page 213 for additional mesh sizes

EPDM - Mesh Screen, 316

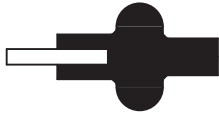

Type 3 - Mesh

Size	Part Number
1"	40MPS-E100
1½"	40MPS-E150
2"	40MPS-E200
2½"	40MPS-E250
3"	40MPS-E300
4"	40MPS-E400

- color code: three green dots
- 10 mesh standard, other materials available, call for details
- peroxide cured
- meets 21CFR 177.2600
- refer to pages 216-218 for compatibility information
- refer to page 213 for additional mesh sizes

FKM (Viton®) - Mesh Screen, 316

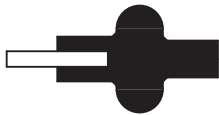

Type 3 - Mesh

Size	Part Number
1"	40MPS-SFY100
1½"	40MPS-SFY150
2"	40MPS-SFY200
2½"	40MPS-SFY250
3"	40MPS-SFY300
4"	40MPS-SFY400

- color code: one white dot, one yellow dot
- 10 mesh standard, other mesh available, call for details
- peroxide cured
- meets 21CFR 177.2600
- refer to pages 216-218 for compatibility information
- refer to page 213 for additional mesh sizes

- see pages 214-215 for sizing charts

Clamp Perforated Gaskets

Buna-N - .033 holes

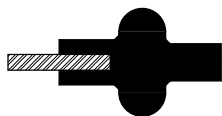

Type 3 - Perforated

- color code: red dot
- perforated metal disc 316 stainless steel sheet
- meets 21CFR 177.2600
- refer to pages 216-218 for compatibility information

Size	Part Number
1"	40MP-UP100
1½"	40MP-UP150
2"	40MP-UP200
2½"	40MP-UP250
3"	40MP-UP300
4"	40MP-UP400

Clamp Orifice Gaskets

Buna-N - Black, 1/8" hole

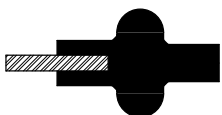

Type 3

- color code: red dot
- 316 stainless steel sheet;
other hole sizes available, call for details
- meets 21CFR 177.2600
- refer to pages 216-218 for compatibility information

Size	Part Number
1"	A80MP-U100
1½"	A80MP-U150
2"	A80MP-U200
2½"	A80MP-U250
3"	A80MP-U300
4"	A80MP-U400

FKM (Viton®) - 1/8" hole

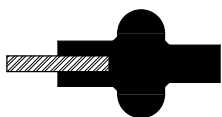

Type 3

- color code: one white dot, one yellow dot
- 316 stainless steel sheet;
other hole sizes available, call for details
- peroxide cured
- meets 21CFR 177.2600
- refer to pages 216-218 for compatibility information

Size	Part Number
1"	A80MP-SFY100
1½"	A80MP-SFY150
2"	A80MP-SFY200
2½"	A80MP-SFY250
3"	A80MP-SFY300
4"	A80MP-SFY400

- see pages 214-215 for sizing charts

Clamp Envelope Gaskets

PTFE (Teflon®) envelope with EPDM filler

Size	Part Number
1/2"	42MP-GRE50
3/4"	42MP-GRE75
1"	40MP-GRE100
1 1/2"	40MP-GRE150
2"	40MP-GRE200
2 1/2"	40MP-GRE250
3"	40MP-GRE300
4"	40MP-GRE400
6"	40MP-GRE600 New



- color code: usually not marked
- peroxide cured EPDM
- meets 21CFR 177.1550
- refer to pages 216-218 for compatibility information

CAUTION

PTFE (Teflon®) is a material subject to plastic flow. When cycled through heat and then cooled down in process lines, PTFE gaskets will not return to the original configuration and it will continue to compress as the cycling continues. This plastic flow will allow leakage if clamp torques are not maintained.

PTFE (Teflon®) envelope with FKM (Viton®) filler

Size	Part Number
1/2"	42MP-GR50
3/4"	42MP-GR75
1"	40MP-GR100
1 1/2"	40MP-GR150
2"	40MP-GR200
2 1/2"	40MP-GR250
3"	40MP-GR300
4"	40MP-GR400
6"	40MP-GR600
8"	40MP-GR800



- color code: usually not marked
- peroxide cured FKM
- meets 21CFR 177.1550
- refer to pages 216-218 for compatibility information

CAUTION

PTFE (Teflon®) is a material subject to plastic flow. When cycled through heat and then cooled down in process lines, PTFE gaskets will not return to the original configuration and it will continue to compress as the cycling continues. This plastic flow will allow leakage if clamp torques are not maintained.

APC Clamp Gaskets

Buna APC - Grey

Size	Part Number
1"	101-H100
1 1/2"	101-H150
2"	101-H200
2 1/2"	101-H250
3"	101-H300
4"	101-H400



- color code: no dot
- meets 21CFR 177.2600
- refer to pages 216-218 for compatibility information

Buna APC - Black

Size	Part Number
1"	101-HX100
1 1/2"	101-HX150
2"	101-HX200
2 1/2"	101-HX250
3"	101-HX300
4"	101-HX400



- color code: no dot
- meets 21CFR 177.2600
- refer to pages 216-218 for compatibility information

- see pages 214-215 for sizing charts