

Over Pressure Protector

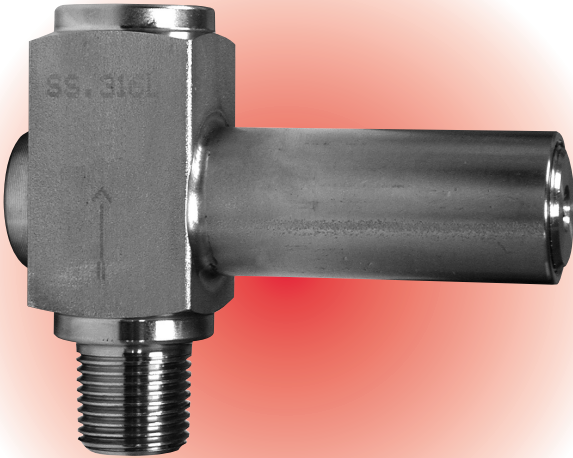

Description

Winters' Over Pressure Protector is utilized to protect pressure instruments against surges and pulsations. Setpoint adjustments are made by manipulating an external adjusting screw and lock nut. The protector automatically shuts off pressure to the instrument once the adjustable preset pressure is exceeded. This instrument is available in Bellows and Piston type.

Specifications:

Body:	Bellows Type: 316 stainless steel Piston Type: 316 stainless steel
Burst Pressure:	10,000 psi/kPa
Connection:	1/4" x 1/4" NPT or 1/2" x 1/2" NPT

How to order: Specify product code

Bellows Type

Part Number	Connection NPT	Adjustable Pressure Range
AGP32025	1/4" x 1/4"	3-20 psi
AGP159025	1/4" x 1/4"	15-90 psi
AGP32050	1/2" x 1/2"	3-20 psi
AGP159050	1/2" x 1/2"	15-90 psi

Piston Type

Part Number	Connection NPT	Adjustable Pressure Range
AGP9023025	1/4" x 1/4"	90-230 psi
AGP14039525	1/4" x 1/4"	140-395 psi
AGP 435116025	1/4" x 1/4"	435-1160 psi
AGP870149325	1/4" x 1/4"	870-1493 psi
AGP1450580025	1/4" x 1/4"	1450-5800 psi
AGP9023050	1/2" x 1/2"	90-230 psi
AGP14039550	1/2" x 1/2"	140-395 psi
AGP435116050	1/2" x 1/2"	435-1160 psi
AGP870149350	1/2" x 1/2"	870-1493 psi
AGP1450580050	1/2" x 1/2"	1450-5800 psi

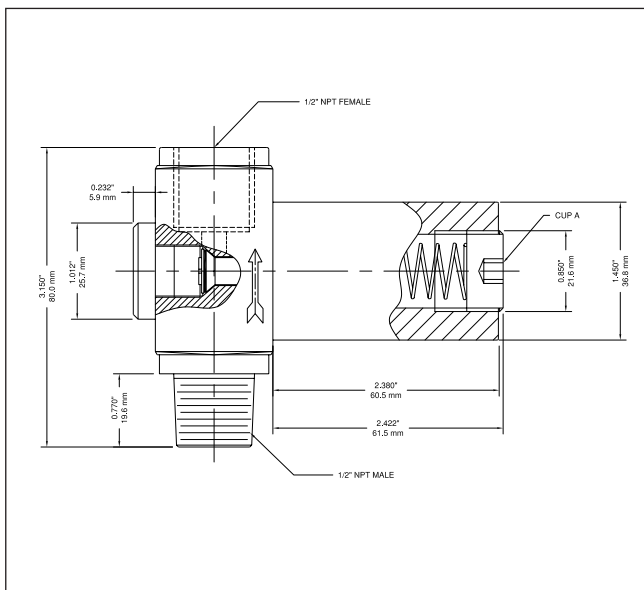

Corporate Office: 121 Railside Road • Toronto • ON • M3A 1B2 • (416) 444-2345 • Fax: (416) 444-8979

U.S.A. Office: 600 Ensminger Road • Buffalo • NY • 14150 • (716) 874-8700 • Fax: (716) 874-8800

www.winters.com • 1-800-WINTERS (946-8377)