

Economy Test



Gas Test Gauge



Water Test Gauge

CRN

Description

Winters Economy Test Gauge is an economical solution for accurate testing of gas, water, air and other pressure media. The gauges are available in 2" (50 mm) and 2½" (63 mm) dials. The Economy Test Gauge is constructed with a steel case and brass internals. Its accuracy rating is ± 3%-2%-3%, ANSI/ASME Grade B. The maxi pointer included on the Water Test Gauge allows you to monitor a peak operating or surge pressure point.

The Winters Economy Test Gauge is CRN registered.

*Pressure rating for Gas Test Gauge is 200 psi normal working pressure, 350 psi max. pressure.

Specifications

Dial:	2" (50 mm) and 2½" (63 mm) white aluminum with black and red markings
Case:	Steel painted black
Lens:	Polycarbonate
Ring:	Steel, painted black
Pointer:	Steel, painted black
Connection:	Adapts to
Gas Test Gauge:	¾" MPT*
Water Test Gauge:	¾" FHT x female npt swivel connection
Maximum Pointer:	¾" female hose
Bourdon Tube:	Phosphor bronze
Movement:	Brass
Welding:	#50 Sn. solder
Working Pressure:	Maximum 75% of full scale value
Ambient / Process Temperature:	-40°F to 150 °F (-40°C to 65°C)
Gas Test:	40°F to 150 °F (-40°C to 65°C)
Water Test:	32°F to 150 °F (0°C to 65°C)
Accuracy:	± 3% -2%-3% accuracy (ANSI/ASME) Grade B
Protection:	IP52



Corporate Office: 121 Railside Road • Toronto • ON • M3A 1B2 • (416) 444-2345 • Fax: (416) 444-8979

U.S.A. Office: 600 Ensminger Road • Buffalo • NY • 14150 • (716) 874-8700 • Fax: (716) 874-8800

www.winters.com • 1-800-WINTERS (946-8377)

Economy Test

How to order: Specify product code

PRODUCT CODES	Gas Test	Water Test
Dial Size	2" (50mm)	2" (50mm) or 2 1/2" (63mm)
Case Material	Steel	Steel
Connection Size	Adapts to 3/4" MPT	3/4" FHT X female NPT Swivel Connection
Movement, Socket, Tube	Brass	Brass
PRODUCT CODES		
0-15 psi/kpa	EGT201	
0-30 psi/kpa	EGT202	
0-60 psi/kpa	EGT203	
0-100 psi/kpa	EGT204	
0-160 psi/kpa		EWT213
0-300 psi/kpa		EWT217

Maximum Pointer Water Test Gauge

Dial size 2 1/2"
 Case Material Steel
 Connection size 3/4" female hose
 Movement, socket, tube Brass

PRODUCT CODES

0-160 psi/kpa ETM213
 0-300 psi/kpa ETM217

2" Gas Test Gauge

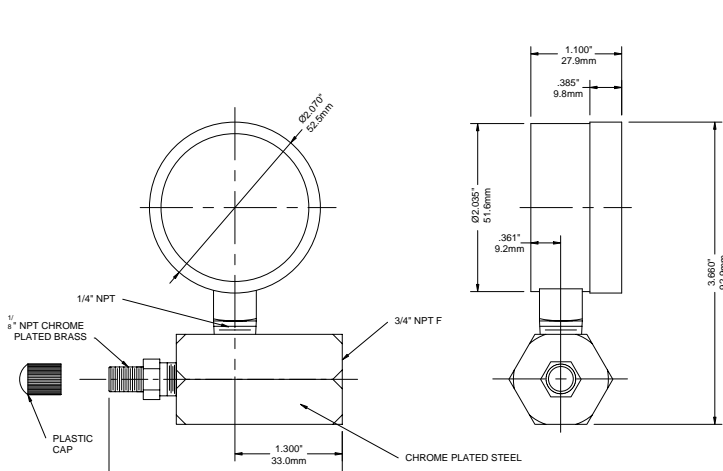

2.5" Water Test Gauge

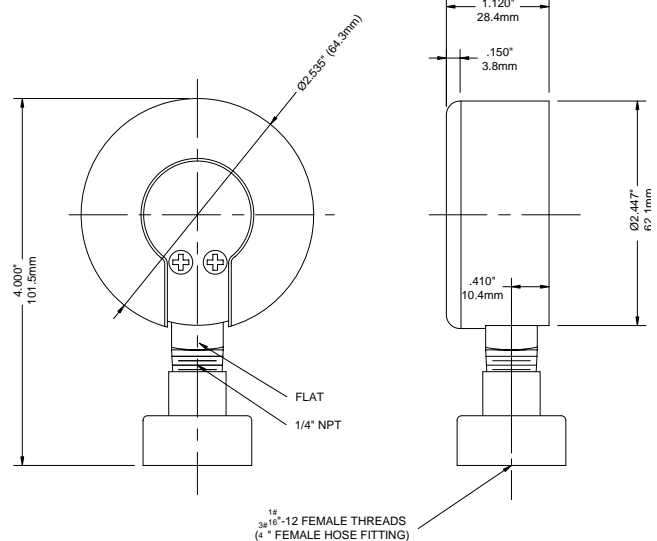

Corporate Office: 121 Railside Road • Toronto • ON • M3A 1B2 • (416) 444-2345 • Fax: (416) 444-8979

U.S.A. Office: 600 Ensminger Road • Buffalo • NY • 14150 • (716) 874-8700 • Fax: (716) 874-8800

www.winters.com • 1-800-WINTERS (946-8377)