

Schaeffer Gauge

STAINLESS STEEL FLANGED DIAPHRAGM



Custom Dials Available

Description

The Schaeffer Gauge is a diaphragm pressure gauge utilized for measuring low positive pressures in an aggressive and highly corrosive media. This pressure gauge is equipped with a concentrically thin corrugated diaphragm clamped between two flanges and the loading of the process fluid causes the diaphragm to deflect upwards or downward.

The Schaeffer Gauge is best suited for applications requiring low pressures* where highly corrosive media is present, such as oil refineries, pulp & paper, chemical plants, and many other industrial applications.

* Vacuum ranges also available.

Specifications

Dial:	4" (100mm) and 6" (150mm) white aluminum with black markings
Case / Ring:	304L stainless steel
Lens:	Acrylic (safety glass optional)
Diaphragm:	316 stainless steel, 316 stainless steel PTFE lined, or Tantalum
Movement:	All stainless steel - Push rod / connecting link and segment
Pointer:	Adjustable pointer - aluminum
Connection:	1/4" or 1/2" NPT standard
Upper Flange:	Stainless steel (neck and base movements)
Lower Flange and Connection:	316L stainless steel bottom connection
Wetted Parts:	316 stainless steel
Ambient Temperature:	-13°F to 140°F (-25°C to 60°C)
Process Temperature:	212°F (100°C)*
Accuracy:	+/-1.5% full scale
Protection:	IP54

* Minimum temperature should not be less than or equal to the freezing point of the process fluid.



Corporate Office: 121 Railside Road • Toronto • ON • M3A 1B2 • (416) 444-2345 • Fax: (416) 444-8979

U.S.A. Office: 600 Ensminger Road • Buffalo • NY • 14150 • (716) 874-8700 • Fax: (716) 874-8800

www.winters.com • 1-800-WINTERS (946-8377)

Schaeffer Gauge

STAINLESS STEEL FLANGED DIAPHRAGM

How to order: Specify product code

Dial Size	4" (100mm)		4" (100mm)		6" (150mm)	
Connection (NPT)	1/4" Bottom	1/2" Bottom	1/4" Bottom	1/2" Bottom	1/4" Bottom	1/2" Bottom
0-10" water/oz	PSG4010	PSG40105			PSG6010	PSG60105
0-30" water/oz	PSG4030	PSG40305			PSG6030	PSG60305
0-60" water/oz	PSG4060	PSG40605			PSG6060	PSG60605
0-100" water/oz	PSG40100	PSG401005			PSG60100	PSG601005
0-160" water/oz	PSG40160	PSG401605			PSG60160	PSG601605
0-200" water/oz	PSG40200	PSG402005			PSG60200	PSG602005
0-300" water/oz	PSG40300	PSG403005			PSG60300	PSG603005
0-10 psi/kPa	PSG410	PSG4105			PSG610	PSG6105
0-15 psi/kPa	PSG415	PSG4155			PSG615	PSG6155
0-30 psi/kPa	PSG430	PSG4305			PSG630	PSG6305
0-60 psi/kPa	PSG460	PSG4605			PSG660	PSG6605
0-100 psi/kPa	PSG4100	PSG41005	PSG4100T	PSG41005T	PSG6100	PSG61005
0-160 psi/kPa	PSG4160	PSG41605			PSG6160	PSG61605
0-200 psi/kPa	PSG4200	PSG42005	PSG4200T	PSG42005T	PSG6200	PSG62005
0-300 psi/kPa	PSG4300	PSG43005	PSG4300T	PSG43005T	PSG6300	PSG63005

T: Denotes Tantalum Diaphragm

Options: 316 stainless steel PTFE lined diaphragm available - please specify PTFE4 - 4" dial or PTFE6 - 6" dial. Other materials, ranges, connections are available upon request.

Safety Glass: SG - 4" dial, SG6 - 6" dial

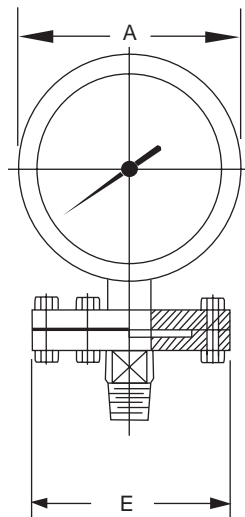

For pressure ranges greater than 0-10 psi/kPa

Case Dia.	Flange Dia.	A	B	C	D	E
4" 100 mm	4" 100 mm	4.43" 112	3.90" 99	2.16" 55	6.99" 177	3.86" 98
6" 150 mm	4" 100 mm	6.10" 155	5.51" 140	2.20" 56	6.99" 177	3.86" 98

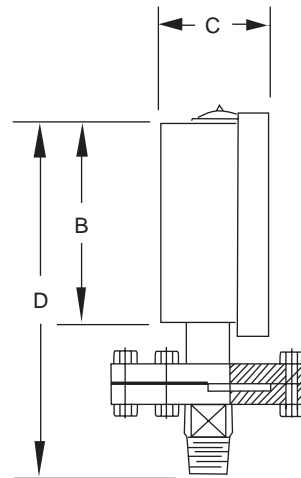

For pressure ranges less than and equal to 10 psi/kPa

Case Dia.	Flange Dia.	A	B	C	D	E
4" 100 mm	6" 150 mm	4.43" 112	3.90" 99	2.16" 55	6.99" 177	6.10" 155
6" 150 mm	6" 150 mm	6.10" 155	5.51" 140	2.20" 56	6.99" 177	6.10" 155



Corporate Office: 121 Railside Road • Toronto • ON • M3A 1B2 • (416) 444-2345 • Fax: (416) 444-8979

U.S.A. Office: 600 Ensminger Road • Buffalo • NY • 14150 • (716) 874-8700 • Fax: (716) 874-8800

www.winters.com • 1-800-WINTERS (946-8377)