

Test Gauge

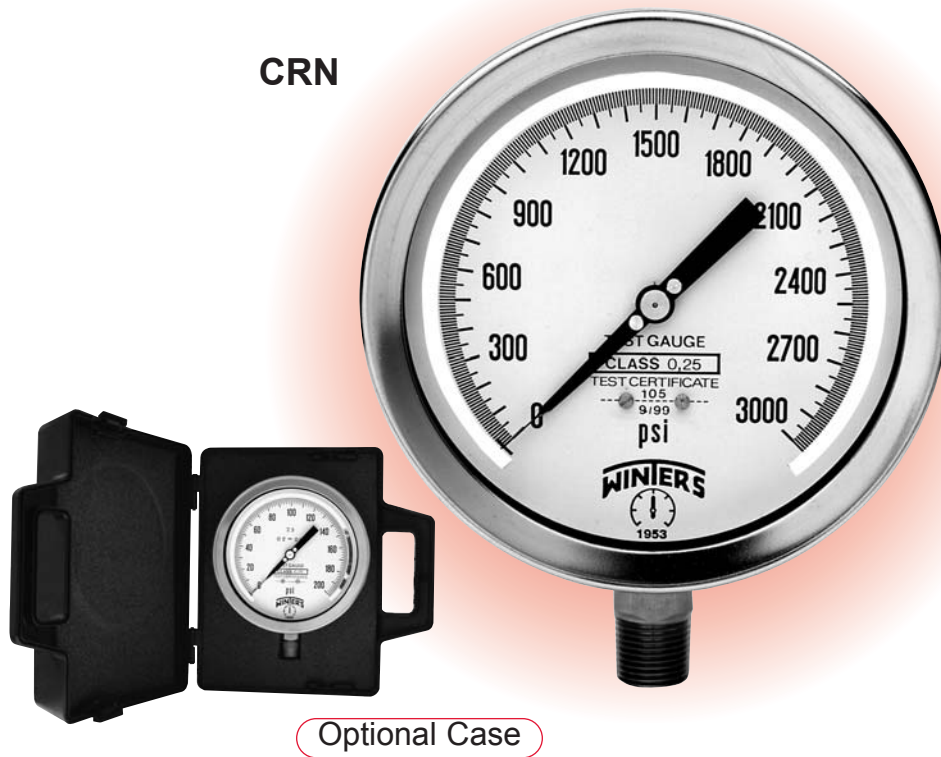

CRN

Optional Case

Description

Winters' Test Gauges are designed specifically for use where accuracy and repeatability are of prime importance such as in laboratories or instrument testing facilities. Constructed of 304 stainless steel casing and brass movements, these gauges offer excellent reliability and have a long service life. The 6" (150mm) Test Gauge features a synthetic jewel bearing for added accuracy - (0.25% full scale). The 4" (100mm) Test Gauge features an accuracy of 0.5%.

Winters' Test Gauges are supplied standard with an NIST traceable test certificate certifying the accuracy of the instrument. The Winters Test Gauge is CRN registered.

An optional carrying case is available for additional protection and transportation purposes.

Specifications

Dial:	4" (100mm) white aluminum dial with black markings, 6" (150mm) white aluminum dial with black markings, both dials have mirror band for precise instrument readings
Case:	AISI 304 stainless steel
Lens:	Polycarbonate
Ring:	AISI 304 stainless steel
Pointer:	Aluminum, anodized black, micrometer adjustable, knife-edge
Socket:	Brass
Connection:	1/4" NPT or 1/2" NPT standard, bottom
Bourdon Tube:	Beryllium Copper
Movement:	4" brass, 6" brass with synthetic jewel bearings
Protection:	IP65
Welding:	Silver alloy
Over-pressure Limit:	30% of full scale value
Working Pressure:	Maximum 75% of full scale value
Calibration Conditions:	68°F (± 5.4°F) 20°C (± 3°C) for ambient and process temperatures at atmospheric pressure
Accuracy:	4" (100mm) ± 0.5% full scale accuracy (ANSI/ASME Grade 2A) 6" (150mm) ± 0.25% full scale accuracy (ANSI/ASME Grade 3A)



Corporate Office: 121 Railside Road • Toronto • ON • M3A 1B2 • (416) 444-2345 • Fax: (416) 444-8979

U.S.A. Office: 600 Ensminger Road • Buffalo • NY • 14150 • (716) 874-8700 • Fax: (716) 874-8800

www.winters.com • 1-800-WINTERS (946-8377)

Test Gauge

How to order: Specify product code
PRODUCT CODES

Dial Size	4" (100mm)	6" (150mm)	4" (100mm)	6" (150mm)
Tube	Beryllium copper	Beryllium copper	Beryllium copper	Beryllium copper
Socket	Brass	Brass	Brass	Brass
Movement	Brass	Brass, with synthetic jewel bearings	Brass	Brass, with synthetic jewel bearings
Connection	Bottom	Bottom	Bottom	Bottom
NPT Connection	1/4"	1/4"	1/2"	1/2"
30"Hg Vacuum	P3999	P1999	*	*
0/15 psi	P4000	P2000	*	*
0/30 psi	P4001	P2001	*	*
0/60 psi	P4002	P2002	*	*
0/100 psi	P4003	P2003	*	*
0/160 psi	P4004	P2004	*	*
0/200 psi	P4005	P2005	*	*
0/300 psi	P4006	P2006	*	*
0/400 psi	P4007	P2007	*	*
0/600 psi	P4008	P2008	*	*
0/1000 psi	*	*	P4009	P2009
0/1600 psi	*	*	P4010	P2010
0/2000 psi	*	*	P4011	P2011
0/3000 psi	*	*	P4012	P2012
0/6000 psi	*	*	P4013	P2013
0/10000 psi	*	*	P4014	P2014

Options:

- 0.10% accuracy available on request.
 - Back connection available upon request.
 - Add the suffix "B" for back connection.
 - Back flange, front flange and u-clamp options available upon request.
 - Other ranges and connection sizes available upon request.
- (Test Gauge Case - 4" - TG4, Test Gauge Case - 6" - TG6)

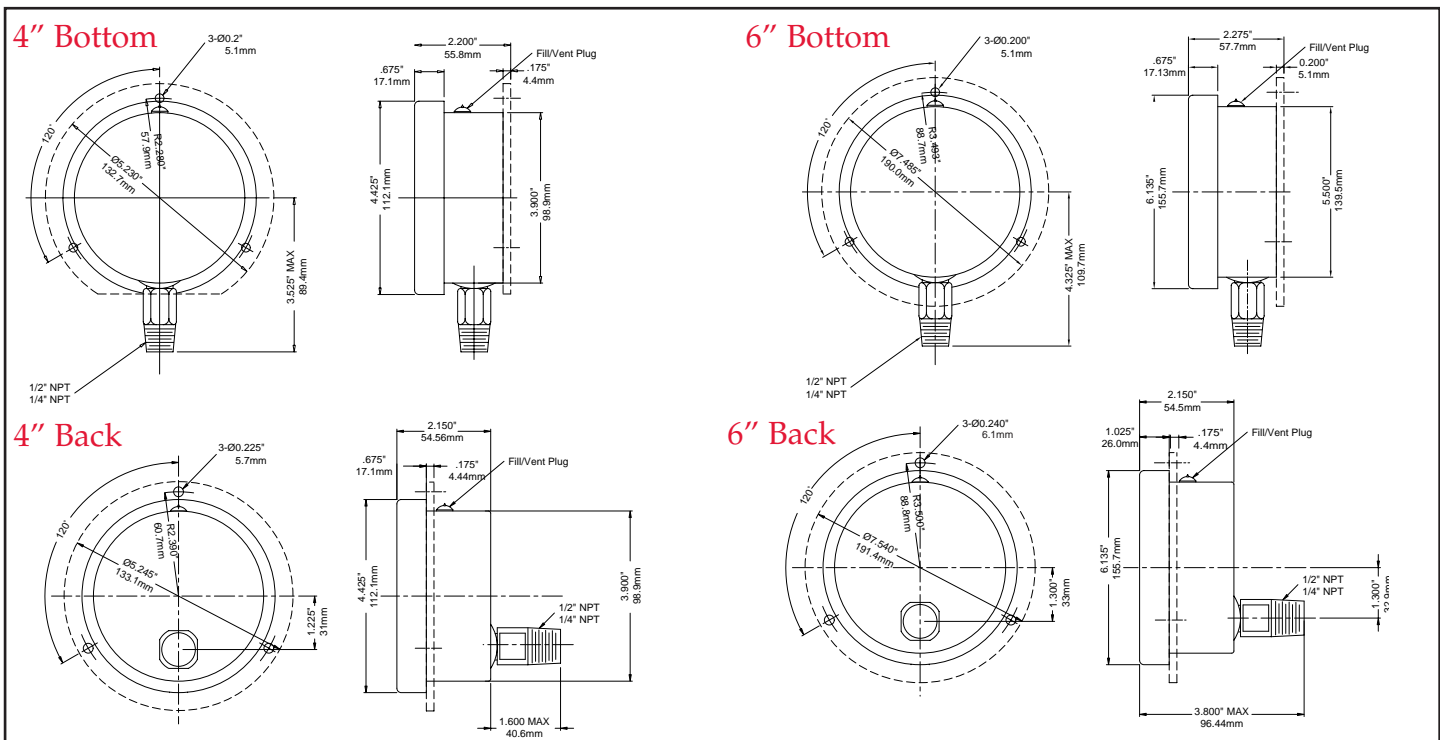

Corporate Office: 121 Railside Road • Toronto • ON • M3A 1B2 • (416) 444-2345 • Fax: (416) 444-8979

U.S.A. Office: 600 Ensminger Road • Buffalo • NY • 14150 • (716) 874-8700 • Fax: (716) 874-8800

www.winters.com • 1-800-WINTERS (946-8377)