

# Surface Magnet Thermometer



## Description

Winters Bi-metal Surface Magnet Thermometers are ideal for use on bearings, ovens, pipes, engines, tanks, dies, molds or any other flat metallic surface that requires accurate temperature monitoring. Available in several ranges, these instruments are permanently calibrated and are guaranteed to be within the specified accuracy.

## Specifications

<b>Dial:</b>	2" (50mm) aluminum with black and red markings
<b>Case:</b>	Steel, painted black
<b>Lens:</b>	Glass
<b>Pointer:</b>	Aluminum, painted black
<b>Movement:</b>	Bi-metallic coil
<b>Ambient/Process Temperature:</b>	Recommended maximum 75% of full scale value
<b>Accuracy:</b>	± 2% of full scale value
<b>Enclosure:</b>	IP52

## How to order: Specify product code PRODUCT CODES

Range	Code
0/250° F & -20/120° C	T7412
0/500° F & -15/260° C	T7410
50/750° F & 10/400° C	T7409

Other ranges available upon request.

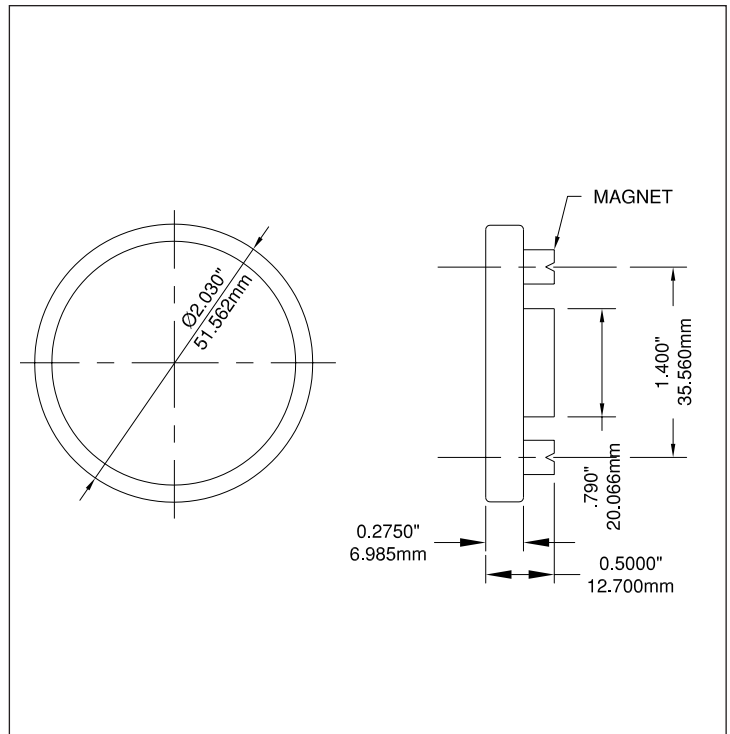

Corporate Office: 121 Railside Road • Toronto • ON • M3A 1B2 • (416) 444-2345 • Fax: (416) 444-8979

U.S.A. Office: 600 Ensminger Road • Buffalo • NY • 14150 • (716) 874-8700 • Fax: (716) 874-8800

[www.winters.com](http://www.winters.com) • 1-800-WINTERS (946-8377)