

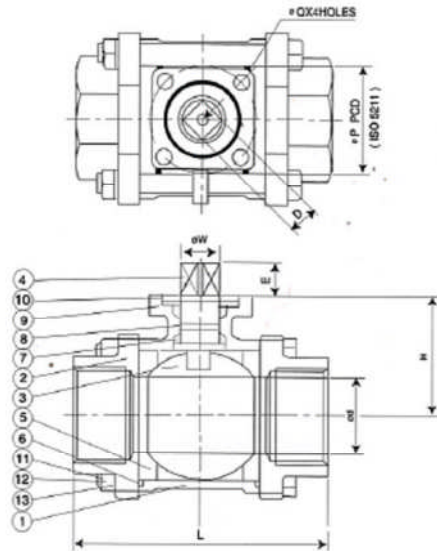

3-PC FULL PORT 1000 WOG BALL VALVE, SCREWED, SOCKET WELD & BUTT WELD WITH MOUNTING PAD ISO 5211 MODEL: #17



STANDARD
DESIGN: ANSI B16.34
TESTING: API 598

APPLICATION
FOR GENERAL CHEMICAL AND INDUSTRIAL SERVICES
STEAM RATING: 150 PSI WSP
TEMPERATURE RANGE: -29°C~+200°C

SPECIFICATION
INVESTMENT CAST BODY & END CAP
END TYPE: THREADED BSP OR NPT, BUTT WELD,
SOCKET WELD 3 PC
DESIGN FOR FAST INSTALLATION & SIMPLE
MAINTENANCE
BOTTOM-LOADED, BLOW-OUT-PROOF STEM

PRESSURE / TEMP. RATINGS

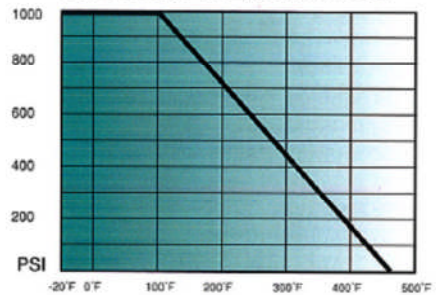

DIMENSIONS (inch)

SIZE	ed	L	H	D	E	W	TORQUE INCH LBS	ISO 5211		LBS
								P	Q	
1/4"	0.44	2.36	1.44	0.35	0.35	0.47	43	F03 1.42	Ø0.24	1.32
3/8"	0.50	2.36	1.44	0.35	0.35	0.47	43	F03 1.42	Ø0.24	1.32
1/2"	0.63	2.95	1.44	0.35	0.35	0.47	43	F03 1.42	Ø0.24	1.34
3/4"	0.79	3.15	1.56	0.35	0.35	0.47	61	F03 1.42	Ø0.24	1.79
1"	0.98	3.54	1.87	0.43	0.43	0.55	87	F04/F05 1.55	Ø0.28	2.56
1-1/4"	1.26	4.33	2.09	0.43	0.43	0.55	130	F04/F05 1.65	Ø0.28	4.10
1-1/2"	1.50	4.72	2.42	0.55	0.55	0.71	173	F05 1.97	Ø0.28	5.67
2"	2.00	5.51	2.78	0.55	0.55	0.71	217	F05 1.97	Ø0.28	9.52
2-1/2"	2.50	6.81	3.78	0.67	0.63	0.87	347	F07 2.78	Ø0.35	22.05
3"	3.00	7.32	4.17	0.67	0.63	0.87	433	F07 2.78	Ø0.35	27.34
4"	3.94	8.86	5.31	0.87	0.79	1.10	650	F10 4.02	Ø0.43	35.94

MATERIAL LIST

NO.	PART NAME	SPECIFICATION
1	BODY	ASTM A351 CF8M
2	END CAPS	ASTM A351 CF8M
3	BALL	ASTM A351 CF8M
4	STEM	S.S. 316
5	BALL SEATS	PTFE
6	END SEALS	PTFE
7	STEM PACKING	PTFE+15%GF
8	O-RING	VITON
9	SPRING DISC	SUS301J1
10	RETAINING RING	S.S. 304
11	BOLTS	S.S. 304
12	BOLT NUTS	S.S. 304
13	BOLT WASHERS	S.S. 304