



The SVF Series H7 is a high pressure ball valve designed to meet applications up to 6,000 psi. The H7 features a carbon or stainless steel body and is available in a variety of alloy materials. This engineered valve adds safety and reliability to high pressure systems and applications in Offshore, Oil & Gas, Petrochemical, Power and Refining.

FEATURES

1/2" - 4"

- 1/2" - 2" 2500 ANSI (6000 psi)
- 3" - 4" 1500 ANSI (3800 psi)
- Designed to ANSI B16.34 and BS 5351
- High pressure to 6,000 psi
- Ideal for use with hydraulics, oil & gas and compressed gas systems
- Blowout-proof stem
- Full range of options
- Available to NACE MR-0175
- Available to API-607-4 and BS 6755



MATERIALS

Item	Description	Material
1	Body	Carbon Steel, 316 Stainless
2	Body Connector	Carbon Steel, 316 Stainless
3	Ball	316 Stainless
4	Stem	17-4 Stainless
5	Valve Seat	Delrin, Peek
6	Body Connector Seal	NBR, Graphite (fire safe)

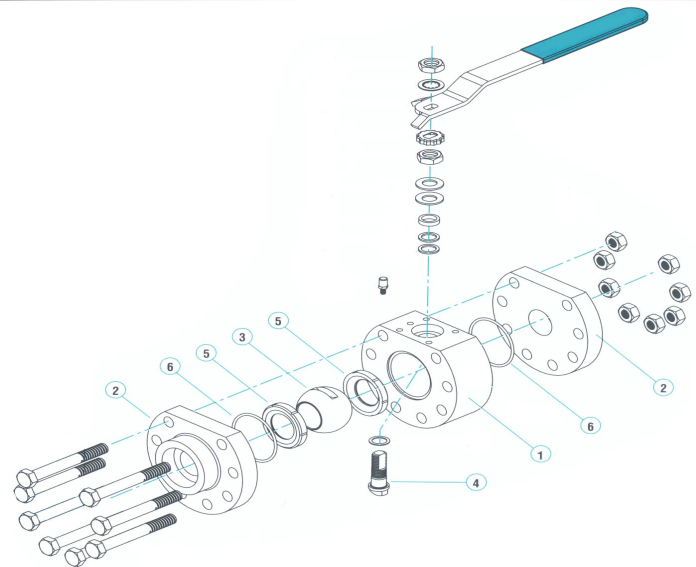

DIMENSIONS & WEIGHTS (ins., lbs.)

Size	A	B	C	D	weight (lbs)
1/2"	2.78	1.5	7.0	0.44	3.52
3/4"	3.49	1.6	7.0	0.56	5.28
1"	3.69	2.2	7.6	0.81	9.90
1-1/4"	4.25	2.4	7.6	1.00	11.88
1-1/2"	5.04	2.9	11.3	1.25	20.90
2"	6.14	3.1	11.3	1.50	28.82
3"	8.82	5.7	15.7	2.50	85.36
4"	10.43	6.3	24.0	3.25	140.14

